

BLU

BLU Series Air-Cooled Condensing Units Technical Catalog for Bitzer Compressors



Standard Features

- Dependable hi-efficiency semi-hermetic compressor
- Direct drive condenser fans
- Liquid receiver with relief valves
- Receiver inlet and outlet valves
- High pressure safety
- Low pressure operating control
- Crankcase heater
- Compressor contactor
- Compressor overload protection
- Fan motor overload protection
- NEMA 3R weatherproof electrical panel
- Hinged control panel access
- Prewired controls
- Compressor service valves
- Low profile
- Liquid injection kit (when required)
- Run/Pumpdown switch
- A20 Flood Control

Applications

Century's BLU Series outdoor air-cooled condensing units are specifically designed for commercial and industrial refrigeration duty cooling applications. They come completely pre-piped and wired with low profile and vertical air discharge condenser coil.

They also utilize a unique condenser and coil design as well as high volume condenser fans to maximize unit performance. The BLU Series condensing unit is suitable for mounting at ground level or rooftop.

Available Options

- Acrylic Coated Fin Coil
- Sight glass
- Liquid line drier (sealed)
- Liquid line drier (replaceable core)
- Liquid line solenoid
- Suction filter (sealed)
- Suction filter (replaceable core)
- Suction accumulator
- Time clock
- Control circuit transformer
- Unit Circuit Breaker
- Unit Phase Failure Monitor
- Indicator Lights
- Off/Pumpdown/Run Switch
- Oil Safety Switch (Optical Switch Required)
- Defrost Time Clock
- Fused Defrost Contactor
- Fused Evaporator Fan Contactor
- Adjustable Guaranteed Off Timer (GOT)
- Elapsed Time Meter
- Alarm Circuit with Dry Contacts
- Heated and Insulated Receiver
- B20 Flood Control with Receiver (below +20°)
- A421 Thermostat with LCD Display (shipped loose)
- Painted Cabinet
- 1/4" Charging Valve
- 3/8" Charging Valve
- Suction Vibrasorter (mounted)



U.S. DEPARTMENT OF
ENERGY

Fully Compliant with 2020 DOE Requirements

See AWEF Tables on Page 34

Construction

Cabinet

The rugged, industrial grade cabinet is constructed of heavy gauge, mill galvanized steel designed for convenient component access. Compressors are mounted low in the cabinet for ease of service. Forklift pockets in the base allow for easy off loading.

Condensers

Coils are seamless copper tube with die stamped aluminum plate fins, galvanized steel frames and tube sheets. Coils are computer selected for refrigeration applications to provide optimum heat transfer at a minimum T.D. Each unit is provided with a separate, sub-cooling circuit to maximize unit performance.

Condenser fan motors are 20" low sound, profiled sickle-shaped blades mounted inside a full bell mouthed housing with a diffuser. The motors are 1550 RPM, weather resistant, three phase with inherent electrical protection.

Coils are mounted horizontally with fans arranged for draw through, vertical discharge air flow.

Liquid Receiver

Receivers are selected to provide pumpdown capacity (with condenser coil) considering a nominal 50ft. equivalent line length and a matching evaporator. Receivers smaller than 6 inches are U.L. listed. All larger receivers are ASME stamped. Each receiver is equipped with inlet and outlet service valves, and pressure relief device.

Compressors

U.L. listed, energy efficient, semi-hermetic, compressors are applied throughout the line. Each compressor is equipped with suction and discharge service valves with gauge ports, inherent three phase overload protection, oil level sight glass, and crankcase heater.

Controls

All reciprocating compressor condensing units are wired to operate on a recycle pumpdown cycle. Run/pumpdown switch is provided as standard.

All electrical control components are enclosed within a heavy-gauge weatherproof, hinged panel to provide maximum weather protection and enhance service analysis.

All units have individually numbered control conductors. Other standard features are adjustable, refrigeration grade, separate high and low pressure switches (high-manual reset); and an individually numbered terminal strip for field connections. Conductors and fusing are selected per N.E.C. standards. Notably all Century control components are selected to be readily available through refrigeration wholesalers throughout the country. O.E.M. type controls are judiciously avoided.

Nomenclature

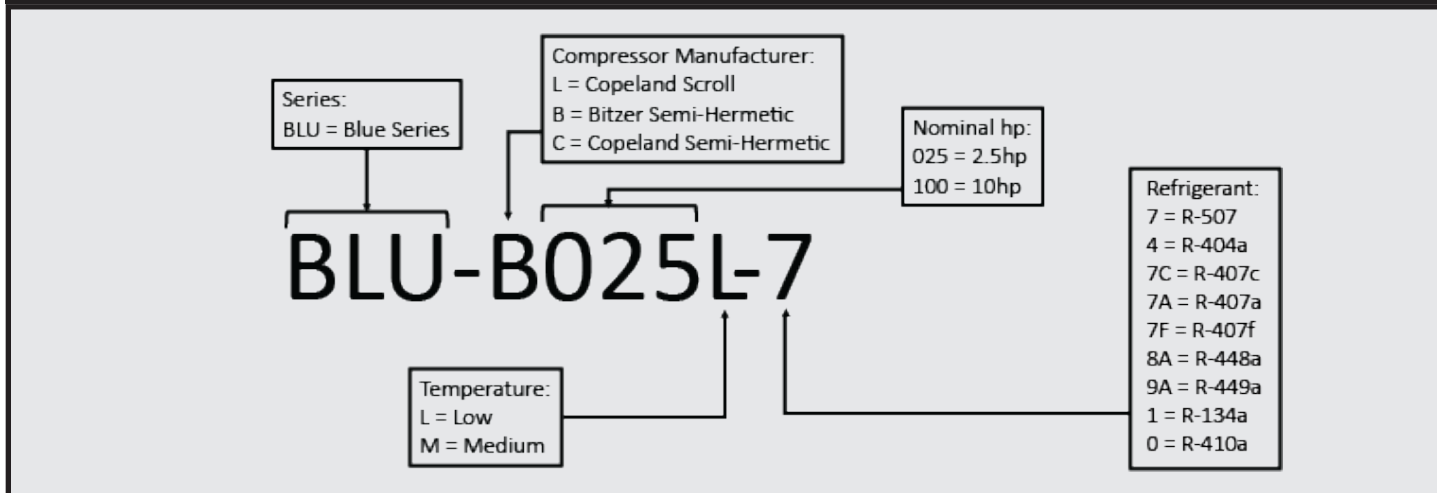

BLU SERIES

NEMA 3R UL508
Electrical Panel

QR Code for
Files & Service
Documentation

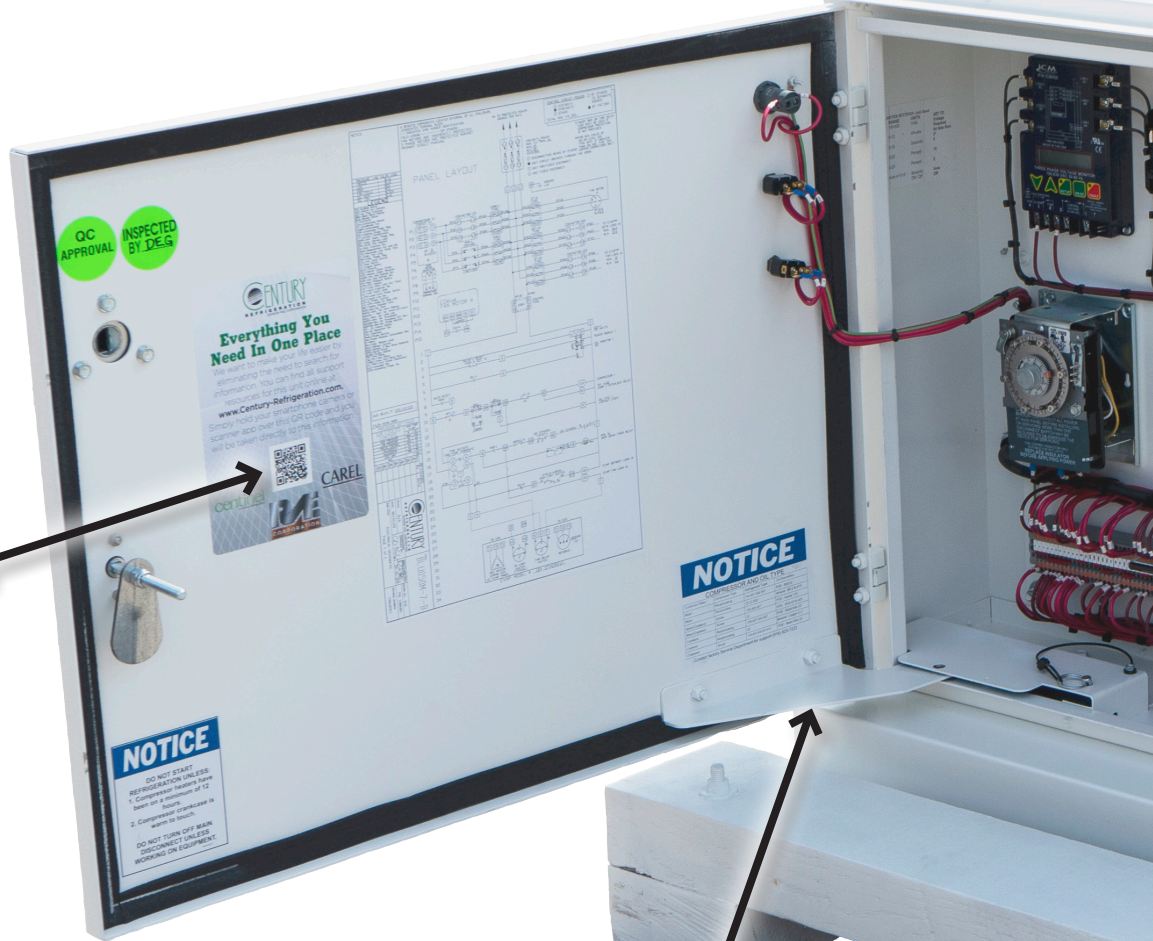

Control Panel Door
Hold Open

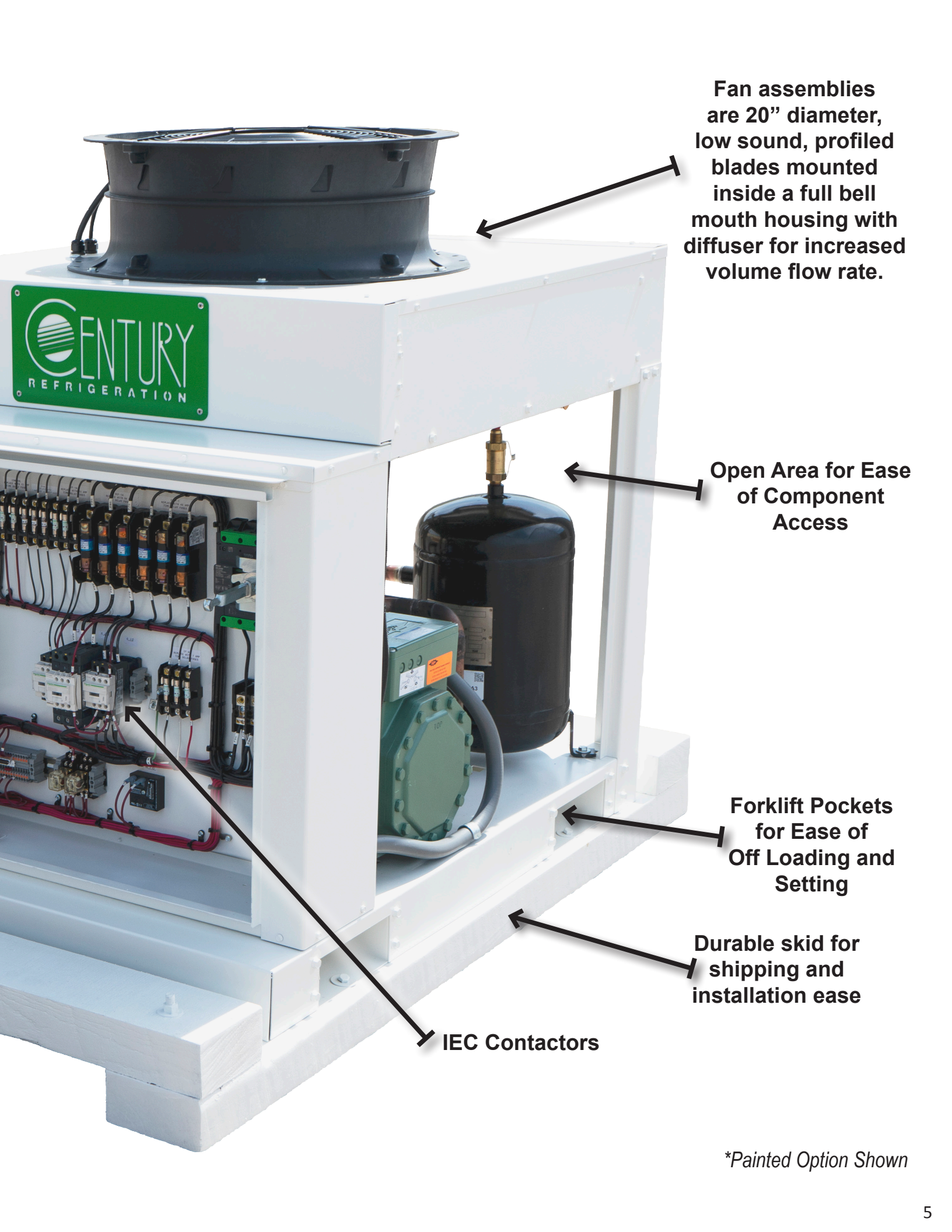

Fan assemblies are 20" diameter, low sound, profiled blades mounted inside a full bell mouth housing with diffuser for increased volume flow rate.

Open Area for Ease of Component Access

Forklift Pockets for Ease of Off Loading and Setting

Durable skid for shipping and installation ease

IEC Contactors

**Painted Option Shown*

| R404a - Medium Temp | | Model Numbers | | | | |
|--|-------------------------------|---------------|-------------|-------------|-------------|-------------|
| | | BLU-B020M-4 | BLU-B025M-4 | BLU-B030M-4 | BLU-B035M-4 | BLU-B040M-4 |
| Compressor Model Number | | 2GES-2 | 2FES-3 | 2EES-3 | 2DES-3 | 2CES-4 |
| Compressor Motor Protection | | INHERENT | | | | |
| Unit MCA ¹ | 208-230/1/60 V | 25.1 | - | 37.6 | 38.5 | - |
| | 208-230/3/60 V | 17.4 | 19.6 | 23.3 | 25.0 | 29.2 |
| | 460/3/60 V | 8.1 | 9.2 | 11.2 | 12.2 | 13.4 |
| Compressor RLA / LRA | 208-230/1/60 V ⁸ | 16.1 | - | 26.1 | 26.8 | - |
| | 208-230/3/60 V | 10.9 | 12.6 | 15.6 | 17.0 | 20.3 |
| | 460/3/60 V | 4.8 | 5.7 | 7.3 | 8.1 | 9.1 |
| Total Number of Condenser Fan Motors | | 1 | 1 | 1 | 1 | 1 |
| Size of Motor (HP) | | 1.2 | 1.2 | 1.2 | 1.2 | 1.2 |
| Diameter of Blade (in.) | | ZN050.DC | ZN050.DC | ZN050.DC | ZN050.DC | ZN050.DC |
| Condenser Fan Motor Amps (each) | 208-230/1/60 V ⁸ | 4 | - | 4 | 4 | - |
| | 208-230/3/60 V | 2.8 | 2.8 | 2.8 | 2.8 | 2.8 |
| | 460/3/60 V | 1.55 | 1.55 | 1.55 | 1.55 | 1.55 |
| Receiver Size per circuit (in.) | | 8.625 x 16 | 8.625 x 16 | 8.625 x 16 | 8.625 x 16 | 8.625 x 16 |
| Receiver Capacity 80% Full per circuit (lbs.) ² | | 23.2 | 23.2 | 23.2 | 23.2 | 23.2 |
| Unit Operating Charge per circuit (approx. lbs.) | Standard ³ | 12.8 | 12.8 | 14.3 | 14.3 | 15.3 |
| | w/ Flood Control ³ | 19.2 | 19.2 | 23.8 | 23.8 | 27 |
| Suction Connection per circuit - ODS (in.) ⁷ | | 7/8 | 7/8 | 7/8 | 7/8 | 7/8 |
| Liquid Line Connection per circuit - ODS (in.) | | 1/2 | 1/2 | 1/2 | 5/8 | 5/8 |
| Unit Shipping Weight - Approximate (lbs.) | | 721 | 727 | 797 | 797 | 805 |
| Unit Operating Weight - Approximate (lbs.) ⁶ | | 707 | 713 | 785 | 785 | 795 |

| Capacity Ratings | | Unit Model Numbers | | | | | | | | | |
|------------------|---------------|--------------------|-----------------|-------------|-----------------|-------------|-----------------|-------------|-----------------|-------------|-----------------|
| Ambient Temp. | Suction Temp. | BLU-B020M-4 | | BLU-B025M-4 | | BLU-B030M-4 | | BLU-B035M-4 | | BLU-B040M-4 | |
| | | Capacity | KW ⁴ | Capacity | KW ⁴ | Capacity | KW ⁴ | Capacity | KW ⁴ | Capacity | KW ⁴ |
| 85° F | 0° F | 12,954 | 2.24 | 15,698 | 2.66 | 20,562 | 3.22 | 24,267 | 3.75 | 29,955 | 4.72 |
| | 10° F | 16,176 | 2.43 | 19,532 | 2.92 | 25,665 | 3.52 | 30,111 | 4.12 | 36,965 | 5.17 |
| | 20° F | 19,863 | 2.62 | 23,743 | 3.17 | 31,456 | 3.81 | 36,363 | 4.50 | 44,321 | 5.64 |
| | 25° F | 21,893 | 2.71 | 25,933 | 3.30 | 34,547 | 3.95 | 39,657 | 4.69 | 48,266 | 5.87 |
| | 30° F | 23,981 | 2.80 | 28,235 | 3.43 | 37,649 | 4.10 | 43,117 | 4.89 | 52,349 | 6.11 |
| | 45° F | 30,628 | 3.08 | 35,620 | 3.83 | 47,823 | 4.52 | 54,202 | 5.47 | 65,432 | 6.82 |
| 95° F | 0° F | 11,614 | 2.32 | 13,997 | 2.75 | 18,477 | 3.31 | 21,802 | 3.86 | 26,987 | 4.87 |
| | 10° F | 14,533 | 2.53 | 17,448 | 3.04 | 23,058 | 3.63 | 27,043 | 4.27 | 33,285 | 5.36 |
| | 20° F | 17,858 | 2.75 | 21,286 | 3.33 | 28,287 | 3.96 | 32,775 | 4.68 | 39,997 | 5.87 |
| | 25° F | 19,696 | 2.85 | 23,258 | 3.47 | 31,127 | 4.12 | 35,783 | 4.89 | 43,538 | 6.12 |
| | 30° F | 21,641 | 2.96 | 25,332 | 3.62 | 34,017 | 4.27 | 38,850 | 5.10 | 47,198 | 6.38 |
| | 45° F | 27,750 | 3.28 | 31,986 | 4.08 | 43,237 | 4.75 | 48,873 | 5.73 | 59,065 | 7.15 |
| 105° F | 0° F | 10,324 | 2.39 | 12,362 | 2.83 | 16,345 | 3.37 | 19,301 | 3.94 | 23,964 | 4.98 |
| | 10° F | 12,934 | 2.63 | 15,407 | 3.15 | 20,441 | 3.72 | 23,939 | 4.38 | 29,527 | 5.52 |
| | 20° F | 15,917 | 2.87 | 18,816 | 3.48 | 25,065 | 4.08 | 29,126 | 4.83 | 35,600 | 6.06 |
| | 25° F | 17,551 | 2.99 | 20,629 | 3.65 | 27,585 | 4.25 | 31,813 | 5.05 | 38,794 | 6.34 |
| | 30° F | 19,297 | 3.11 | 22,477 | 3.81 | 30,268 | 4.43 | 34,584 | 5.28 | 42,037 | 6.61 |
| | 45° F | 24,876 | 3.48 | - | - | 38,614 | 4.94 | - | - | - | - |

1 - MCA (Minimum Circuit Ampacity) is calculated based on all concurrent loads applied to the circuit. (Largest load x 1.25 + 100% of all other loads including the control circuit.) Unit cooler amperages not included.

2 - Based on 80% full at 90°F ambient.

3 - Based on 50 ft. of equivalent refrigerant line piping. (Does not include the evaporator.)

4 - KW is for the unit.

5 - Rated in accordance with ANSI/AHRI Standard 520-2004.

6 - Operating weight reflects flooded refrigerant charge.

7 - Size based on mounted optional suction line trim.

8 - Contact factory to confirm single phase application selections.

“-” - Consult your local Century Representative.

NOTE: Compressor amps are based on the maximum cataloged suction temperature for the condensing unit. Limiting the operation to this envelope is required via a MOP expansion valve or other means.

| R404a - Medium Temp | | Model Numbers | | | |
|--|-------------------------------|----------------------|--------------------|--------------------|--------------------|
| | | BLU-B050M-4 | BLU-B060M-4 | BLU-B075M-4 | BLU-B090M-4 |
| Compressor Model Number | | 4FES-5 | 4EES-6 | 4DES-7 | 4CES-9 |
| Compressor Motor Protection | | INHERENT | | | |
| Unit MCA¹ | 208-230/1/60 V | - | - | - | - |
| | 208-230/3/60 V | 40.0 | 40.8 | 46.1 | 56.3 |
| | 460/3/60 V | 18.4 | 18.8 | 21.2 | 25.8 |
| Compressor RLA / LRA | 208-230/1/60 V | - | - | - | - |
| | 208-230/3/60 V | 29.0 | 29.6 | 33.8 | 42.0 |
| | 460/3/60 V | 13.1 | 13.4 | 15.3 | 19.0 |
| Total Number of Condenser Fan Motors | | 1 | 1 | 1 | 1 |
| Size of Motor (HP) | | 1.2 | 1.2 | 1.2 | 1.2 |
| Diameter of Blade (in.) | | ZN050.DC | ZN050.DC | ZN050.DC | ZN050.DC |
| Condenser Fan Motor Amps (each) | 208-230/1/60 V ⁸ | - | - | - | - |
| | 208-230/3/60 V | 2.8 | 2.8 | 2.8 | 2.8 |
| | 460/3/60 V | 1.55 | 1.55 | 1.55 | 1.55 |
| Receiver Size per circuit (in.) | | 8.625 x 16 | 10.75 x 18 | 10.75 x 18 | 10.75 x 18 |
| Receiver Capacity 80% Full per circuit (lbs.)² | | 23.2 | 39.2 | 39.2 | 39.2 |
| Unit Operating Charge per circuit (approx. lbs.) | Standard ³ | 17.1 | 22.7 | 22.9 | 22.9 |
| | w/ Flood Control ³ | 28.8 | 39.2 | 39.4 | 39.4 |
| Suction Connection per circuit - ODS (in.)⁷ | | 7/8 | 1 1/8 | 1 1/8 | 1 1/8 |
| Liquid Line Connection per circuit - ODS (in.) | | 5/8 | 5/8 | 7/8 | 7/8 |
| Unit Shipping Weight - Approximate (lbs.) | | 845 | 860 | 866 | 872 |
| Unit Operating Weight - Approximate (lbs.)⁶ | | 822 | 845 | 851 | 856 |

| Capacity Ratings | | | | | | | | | |
|-------------------------|----------------------|--------------------|-----------------------|--------------------|-----------------------|--------------------|-----------------------|--------------------|-----------------------|
| Ambient Temp. | Suction Temp. | BLU-B050M-4 | | BLU-B060M-4 | | BLU-B075M-4 | | BLU-B090M-4 | |
| | | Capacity | KW⁴ | Capacity | KW⁴ | Capacity | KW⁴ | Capacity | KW⁴ |
| 85° F | 0° F | 30,131 | 5.10 | 39,644 | 6.15 | 46,483 | 7.28 | 53,491 | 8.70 |
| | 10° F | 36,938 | 5.58 | 48,736 | 6.81 | 56,430 | 8.10 | 64,511 | 9.83 |
| | 20° F | 44,493 | 6.05 | 58,554 | 7.47 | 67,254 | 8.93 | 76,472 | 11.00 |
| | 25° F | 48,543 | 6.28 | 63,795 | 7.80 | 73,039 | 9.35 | 82,785 | 11.61 |
| | 30° F | 52,743 | 6.51 | 69,300 | 8.13 | 79,003 | 9.77 | 89,263 | 12.23 |
| | 45° F | 66,409 | 7.16 | 86,882 | 9.10 | 97,968 | 11.04 | - | - |
| 95° F | 0° F | 27,198 | 5.26 | 35,566 | 6.33 | 41,918 | 7.51 | 48,093 | 8.94 |
| | 10° F | 33,275 | 5.78 | 43,838 | 7.04 | 50,838 | 8.38 | 58,077 | 10.13 |
| | 20° F | 40,060 | 6.28 | 52,753 | 7.75 | 60,600 | 9.26 | 68,927 | 11.38 |
| | 25° F | 43,671 | 6.53 | 57,449 | 8.11 | 65,872 | 9.71 | - | - |
| | 30° F | 47,476 | 6.78 | 62,386 | 8.46 | 71,218 | 10.16 | - | - |
| | 45° F | 59,763 | 7.48 | - | - | - | - | - | - |
| 105° F | 0° F | 24,200 | 5.39 | 31,494 | 6.48 | 37,308 | 7.69 | 42,752 | 9.14 |
| | 10° F | 29,590 | 5.94 | 38,939 | 7.23 | 45,213 | 8.61 | - | - |
| | 20° F | 35,566 | 6.48 | 46,844 | 7.99 | - | - | - | - |
| | 25° F | 38,800 | 6.74 | - | - | - | - | - | - |
| | 30° F | 42,156 | 7.00 | - | - | - | - | - | - |
| | 45° F | - | - | - | - | - | - | - | - |

1 - MCA (Minimum Circuit Ampacity) is calculated based on all concurrent loads applied to the circuit. (Largest load x 1.25 + 100% of all other loads including the control circuit.) Unit cooler amperages not included.

2 - Based on 80% full at 90°F ambient.

3 - Based on 50 ft. of equivalent refrigerant line piping. (Does not include the evaporator.)

4 - KW is for the unit.

5 - Rated in accordance with ANSI/AHRI Standard 520-2004.

6 - Operating weight reflects flooded refrigerant charge.

7 - Size based on mounted optional suction line trim.

8 - Contact factory to confirm single phase application selections.

"-" - Consult your local Century Representative.

NOTE: Compressor amps are based on the maximum cataloged suction temperature for the condensing unit. Limiting the operation to this envelope is required via a MOP expansion valve or other means.

| R507 - Medium Temp | | Model Numbers | | | | |
|--|-------------------------------|----------------------|--------------------|--------------------|--------------------|--------------------|
| | | BLU-B020M-7 | BLU-B025M-7 | BLU-B030M-7 | BLU-B035M-7 | BLU-B040M-7 |
| Compressor Model Number | | 2GES-2 | 2FES-3 | 2EES-3 | 2DES-3 | 2CES-4 |
| Compressor Motor Protection | | INHERENT | | | | |
| Unit MCA¹ | 208-230/1/60 V | 25.1 | - | 37.6 | 38.5 | - |
| | 208-230/3/60 V | 17.4 | 19.6 | 23.3 | 25.0 | 29.2 |
| | 460/3/60 V | 8.1 | 9.2 | 11.2 | 12.2 | 13.4 |
| Compressor RLA / LRA | 208-230/1/60 V | 16.1 | - | 26.1 | 26.8 | - |
| | 208-230/3/60 V | 10.9 | 12.6 | 15.6 | 17.0 | 20.3 |
| | 460/3/60 V | 4.8 | 5.7 | 7.3 | 8.1 | 9.1 |
| Total Number of Condenser Fan Motors | | 1 | 1 | 1 | 1 | 1 |
| Size of Motor (HP) | | 1.2 | 1.2 | 1.2 | 1.2 | 1.2 |
| Diameter of Blade (in.) | | ZN050.DC | ZN050.DC | ZN050.DC | ZN050.DC | ZN050.DC |
| Condenser Fan Motor Amps (each) | 208-230/1/60 V ⁸ | 4 | - | 4 | 4 | - |
| | 208-230/3/60 V | 2.8 | 2.8 | 2.8 | 2.8 | 2.8 |
| | 460/3/60 V | 1.55 | 1.55 | 1.55 | 1.55 | 1.55 |
| Receiver Size per circuit (in.) | | 8.625 x 16 | 8.625 x 16 | 8.625 x 16 | 8.625 x 16 | 8.625 x 16 |
| Receiver Capacity 80% Full per circuit (lbs.)² | | 23.2 | 23.2 | 23.2 | 23.2 | 23.2 |
| Unit Operating Charge per circuit (approx. lbs.) | Standard ³ | 12.8 | 12.8 | 14.3 | 14.3 | 15.3 |
| | w/ Flood Control ³ | 19.2 | 19.2 | 23.8 | 23.8 | 27 |
| Suction Connection per circuit - ODS (in.)⁷ | | 7/8 | 7/8 | 7/8 | 7/8 | 7/8 |
| Liquid Line Connection per circuit - ODS (in.) | | 1/2 | 1/2 | 1/2 | 5/8 | 5/8 |
| Unit Shipping Weight - Approximate (lbs.) | | 721 | 727 | 797 | 797 | 805 |
| Unit Operating Weight - Approximate (lbs.)⁶ | | 707 | 713 | 785 | 785 | 795 |

| Capacity Ratings | | Unit Model Numbers | | | | | | | | | |
|-------------------------|----------------------|---------------------------|-----------------------|--------------------|-----------------------|--------------------|-----------------------|--------------------|-----------------------|--------------------|-----------------------|
| Ambient Temp. | Suction Temp. | BLU-B020M-7 | | BLU-B025M-7 | | BLU-B030M-7 | | BLU-B035M-7 | | BLU-B040M-7 | |
| | | Capacity | KW⁴ | Capacity | KW⁴ | Capacity | KW⁴ | Capacity | KW⁴ | Capacity | KW⁴ |
| 85° F | 0° F | 13,361 | 2.25 | 16,186 | 2.66 | 21,209 | 3.22 | 25,018 | 3.75 | 30,867 | 4.72 |
| | 10° F | 16,627 | 2.44 | 20,062 | 2.92 | 26,376 | 3.52 | 30,923 | 4.13 | 37,864 | 5.18 |
| | 20° F | 20,349 | 2.62 | 24,273 | 3.18 | 32,215 | 3.81 | 37,166 | 4.51 | 45,226 | 5.65 |
| | 25° F | 22,376 | 2.72 | 26,464 | 3.31 | 35,246 | 3.96 | 40,457 | 4.70 | 49,159 | 5.88 |
| | 30° F | 24,438 | 2.81 | 28,727 | 3.44 | 38,390 | 4.10 | 43,855 | 4.90 | 53,216 | 6.12 |
| | 45° F | 31,102 | 3.08 | 36,045 | 3.84 | 48,522 | 4.53 | 54,818 | 5.48 | 66,207 | 6.83 |
| 95° F | 0° F | 11,975 | 2.32 | 14,425 | 2.75 | 19,032 | 3.31 | 22,459 | 3.86 | 27,757 | 4.87 |
| | 10° F | 14,923 | 2.54 | 17,882 | 3.04 | 23,669 | 3.64 | 27,705 | 4.27 | 34,079 | 5.37 |
| | 20° F | 18,266 | 2.75 | 21,728 | 3.33 | 28,893 | 3.96 | 33,395 | 4.69 | 40,724 | 5.88 |
| | 25° F | 20,092 | 2.86 | 23,690 | 3.48 | 31,731 | 4.12 | 36,382 | 4.89 | 44,233 | 6.13 |
| | 30° F | 22,035 | 2.96 | 25,715 | 3.63 | 34,575 | 4.28 | 39,467 | 5.10 | 47,908 | 6.38 |
| | 45° F | 28,075 | 3.28 | 32,311 | 4.08 | 43,753 | 4.75 | 49,330 | 5.74 | 59,556 | 7.15 |
| 105° F | 0° F | 10,622 | 2.39 | 12,707 | 2.83 | 16,811 | 3.37 | 19,827 | 3.94 | 24,594 | 4.99 |
| | 10° F | 13,241 | 2.63 | 15,733 | 3.16 | 20,916 | 3.73 | 24,458 | 4.38 | 30,137 | 5.52 |
| | 20° F | 16,220 | 2.87 | 19,136 | 3.48 | 25,527 | 4.08 | 29,592 | 4.83 | 36,118 | 6.07 |
| | 25° F | 17,846 | 3.00 | 20,913 | 3.65 | 28,029 | 4.25 | 32,230 | 5.06 | 39,261 | 6.34 |
| | 30° F | 19,579 | 3.12 | 22,731 | 3.82 | 30,686 | 4.43 | 34,950 | 5.28 | 42,430 | 6.62 |
| | 45° F | 25,101 | 3.48 | - | - | 38,923 | 4.94 | - | - | - | - |

- 1 - MCA (Minimum Circuit Ampacity) is calculated based on all concurrent loads applied to the circuit. (Largest load x 1.25 + 100% of all other loads including the control circuit.) Unit cooler amperages not included.
- 2 - Based on 80% full at 90°F ambient.
- 3 - Based on 50 ft. of equivalent refrigerant line piping. (Does not include the evaporator.)
- 4 - KW is for the unit.
- 5 - Rated in accordance with ANSI/AHRI Standard 520-2004.
- 6 - Operating weight reflects flooded refrigerant charge.
- 7 - Size based on mounted optional suction line trim.
- 8 - Contact factory to confirm single phase application selections.

“-” - Consult your local Century Representative.

NOTE: Compressor amps are based on the maximum cataloged suction temperature for the condensing unit. Limiting the operation to this envelope is required via a MOP expansion valve or other means.

| R507 - Medium Temp | | Model Numbers | | | |
|--|-------------------------------------|----------------------|--------------------|--------------------|--------------------|
| | | BLU-B050M-7 | BLU-B060M-7 | BLU-B075M-7 | BLU-B090M-7 |
| Compressor Model Number | | 4FES-5 | 4EES-6 | 4DES-7 | 4CES-9 |
| Compressor Motor Protection | | INHERENT | | | |
| Unit MCA¹ | 208-230/1/60 V | - | - | - | - |
| | 208-230/3/60 V | 40.0 | 40.8 | 46.1 | 56.3 |
| | 460/3/60 V | 18.4 | 18.8 | 21.2 | 25.8 |
| Compressor RLA / LRA | 208-230/1/60 V | - | - | - | - |
| | 208-230/3/60 V | 29.0 | 29.6 | 33.8 | 42.0 |
| | 460/3/60 V | 13.1 | 13.4 | 15.3 | 19.0 |
| Total Number of Condenser Fan Motors | | 1 | 1 | 1 | 1 |
| Size of Motor (HP) | | 1.2 | 1.2 | 1.2 | 1.2 |
| Diameter of Blade (in.) | | ZN050.DC | ZN050.DC | ZN050.DC | ZN050.DC |
| Condenser Fan Motor Amps (each) | 208-230/1/60 V⁸ | - | - | - | - |
| | 208-230/3/60 V | 2.8 | 2.8 | 2.8 | 2.8 |
| | 460/3/60 V | 1.55 | 1.55 | 1.55 | 1.55 |
| Receiver Size per circuit (in.) | | 8.625 x 16 | 10.75 x 18 | 10.75 x 18 | 10.75 x 18 |
| Receiver Capacity 80% Full per circuit (lbs.)² | | 23.2 | 39.2 | 39.2 | 39.2 |
| Unit Operating Charge per circuit (approx. lbs.) | Standard³ | 17.1 | 22.7 | 22.9 | 22.9 |
| | w/ Flood Control³ | 28.8 | 39.2 | 39.4 | 39.4 |
| Suction Connection per circuit - ODS (in.)⁷ | | 7/8 | 1 1/8 | 1 1/8 | 1 1/8 |
| Liquid Line Connection per circuit - ODS (in.) | | 5/8 | 5/8 | 7/8 | 7/8 |
| Unit Shipping Weight - Approximate (lbs.) | | 845 | 860 | 866 | 872 |
| Unit Operating Weight - Approximate (lbs.)⁶ | | 822 | 845 | 851 | 856 |

| Capacity Ratings | | | | | | | | | |
|-------------------------|----------------------|--------------------|-----------------------|--------------------|-----------------------|--------------------|-----------------------|--------------------|-----------------------|
| Ambient Temp. | Suction Temp. | BLU-B050M-7 | | BLU-B060M-7 | | BLU-B075M-7 | | BLU-B090M-7 | |
| | | Capacity | KW⁴ | Capacity | KW⁴ | Capacity | KW⁴ | Capacity | KW⁴ |
| 85° F | 0° F | 30,914 | 5.09 | 40,723 | 6.13 | 47,642 | 7.27 | 54,853 | 8.68 |
| | 10° F | 37,733 | 5.57 | 49,771 | 6.79 | 57,580 | 8.08 | 65,764 | 9.81 |
| | 20° F | 45,329 | 6.04 | 59,612 | 7.45 | 68,351 | 8.92 | 77,513 | 10.98 |
| | 25° F | 49,349 | 6.27 | 64,794 | 7.79 | 74,021 | 9.34 | 83,587 | 11.59 |
| | 30° F | 53,495 | 6.50 | 70,210 | 8.12 | 79,823 | 9.76 | 89,875 | 12.21 |
| | 45° F | 66,915 | 7.15 | 87,507 | 9.08 | 98,238 | 11.02 | - | - |
| 95° F | 0° F | 27,901 | 5.25 | 36,561 | 6.32 | 42,981 | 7.49 | 49,297 | 8.92 |
| | 10° F | 34,019 | 5.76 | 44,801 | 7.02 | 51,804 | 8.36 | 59,041 | 10.11 |
| | 20° F | 40,680 | 6.27 | 53,522 | 7.74 | 61,396 | 9.24 | 69,509 | 11.35 |
| | 25° F | 44,275 | 6.52 | 58,176 | 8.09 | 66,487 | 9.69 | - | - |
| | 30° F | 47,982 | 6.76 | 62,962 | 8.45 | 71,697 | 10.13 | - | - |
| | 45° F | 59,955 | 7.46 | - | - | - | - | - | - |
| 105° F | 0° F | 24,835 | 5.38 | 32,313 | 6.46 | 38,188 | 7.67 | 43,644 | 9.12 |
| | 10° F | 30,172 | 5.92 | 39,696 | 7.22 | 45,938 | 8.59 | - | - |
| | 20° F | 35,993 | 6.46 | 47,352 | 7.98 | - | - | - | - |
| | 25° F | 39,108 | 6.73 | - | - | - | - | - | - |
| | 30° F | 42,382 | 6.99 | - | - | - | - | - | - |
| | 45° F | - | - | - | - | - | - | - | - |

1 - MCA (Minimum Circuit Ampacity) is calculated based on all concurrent loads applied to the circuit. (Largest load x 1.25 + 100% of all other loads including the control circuit.) Unit cooler amperages not included.

2 - Based on 80% full at 90°F ambient.

3 - Based on 50 ft. of equivalent refrigerant line piping. (Does not include the evaporator.)

4 - KW is for the unit.

5 - Rated in accordance with ANSI/AHRI Standard 520-2004.

6 - Operating weight reflects flooded refrigerant charge.

7 - Size based on mounted optional suction line trim.

8 - Contact factory to confirm single phase application selections.

“-” - Consult your local Century Representative.

NOTE: Compressor amps are based on the maximum cataloged suction temperature for the condensing unit. Limiting the operation to this envelope is required via a MOP expansion valve or other means.

| R448a - Medium Temp | | Model Numbers | | | | |
|--|-------------------------------------|----------------------|---------------------|---------------------|---------------------|---------------------|
| | | BLU-B020M-8A | BLU-B025M-8A | BLU-B030M-8A | BLU-B035M-8A | BLU-B040M-8A |
| Compressor Model Number | | 2GES-2 | 2FES-3 | 2EES-3 | 2DES-3 | 2CES-4 |
| Compressor Motor Protection | | INHERENT | | | | |
| Unit MCA¹ | 208-230/1/60 V | 25.1 | - | 37.6 | 38.5 | - |
| | 208-230/3/60 V | 17.4 | 19.6 | 23.3 | 25.0 | 29.2 |
| | 460/3/60 V | 8.1 | 9.2 | 11.2 | 12.2 | 13.4 |
| Compressor RLA / LRA | 208-230/1/60 V | 16.1 | - | 26.1 | 26.8 | - |
| | 208-230/3/60 V | 10.9 | 12.6 | 15.6 | 17.0 | 20.3 |
| | 460/3/60 V | 4.8 | 5.7 | 7.3 | 8.1 | 9.1 |
| Total Number of Condenser Fan Motors | | 1 | 1 | 1 | 1 | 1 |
| Size of Motor (HP) | | 1.2 | 1.2 | 1.2 | 1.2 | 1.2 |
| Diameter of Blade (in.) | | ZN050.DC | ZN050.DC | ZN050.DC | ZN050.DC | ZN050.DC |
| Condenser Fan Motor Amps (each) | 208-230/1/60 V⁸ | 4 | - | 4 | 4 | - |
| | 208-230/3/60 V | 2.8 | 2.8 | 2.8 | 2.8 | 2.8 |
| | 460/3/60 V | 1.55 | 1.55 | 1.55 | 1.55 | 1.55 |
| Receiver Size per circuit (in.) | | 8.625 x 16 | 8.625 x 16 | 8.625 x 16 | 8.625 x 16 | 8.625 x 16 |
| Receiver Capacity 80% Full per circuit (lbs.)² | | 23.2 | 23.2 | 23.2 | 23.2 | 23.2 |
| Unit Operating Charge per circuit (approx. lbs.) | Standard³ | 12.8 | 12.8 | 14.3 | 14.3 | 15.3 |
| | w/ Flood Control³ | 19.2 | 19.2 | 23.8 | 23.8 | 27 |
| Suction Connection per circuit - ODS (in.)⁷ | | 7/8 | 7/8 | 7/8 | 7/8 | 7/8 |
| Liquid Line Connection per circuit - ODS (in.) | | 1/2 | 1/2 | 1/2 | 5/8 | 5/8 |
| Unit Shipping Weight - Approximate (lbs.) | | 721 | 727 | 797 | 797 | 805 |
| Unit Operating Weight - Approximate (lbs.)⁶ | | 707 | 713 | 785 | 785 | 795 |

| Capacity Ratings | | Unit Model Numbers | | | | | | | | | |
|-------------------------|----------------------|---------------------------|-----------------------|---------------------|-----------------------|---------------------|-----------------------|---------------------|-----------------------|---------------------|-----------------------|
| Ambient Temp. | Suction Temp. | BLU-B020M-8A | | BLU-B025M-8A | | BLU-B030M-8A | | BLU-B035M-8A | | BLU-B040M-8A | |
| | | Capacity | KW⁴ | Capacity | KW⁴ | Capacity | KW⁴ | Capacity | KW⁴ | Capacity | KW⁴ |
| 85° F | 0° F | 11,199 | 2.03 | 13,948 | 2.45 | 17,704 | 2.97 | 21,004 | 3.43 | 25,977 | 4.33 |
| | 10° F | 14,509 | 2.23 | 17,987 | 2.73 | 22,765 | 3.27 | 26,868 | 3.81 | 33,063 | 4.79 |
| | 20° F | 18,398 | 2.42 | 22,671 | 2.99 | 28,730 | 3.57 | 33,741 | 4.20 | 41,338 | 5.26 |
| | 25° F | 20,578 | 2.52 | 25,291 | 3.12 | 32,083 | 3.72 | 37,560 | 4.40 | 45,886 | 5.50 |
| | 30° F | 22,917 | 2.60 | 28,011 | 3.25 | 35,670 | 3.86 | 41,502 | 4.59 | 50,570 | 5.74 |
| 95° F | 0° F | 10,104 | 2.07 | 12,568 | 2.51 | 16,067 | 3.04 | 19,095 | 3.52 | 23,700 | 4.46 |
| | 10° F | 13,130 | 2.30 | 16,248 | 2.81 | 20,748 | 3.38 | 24,509 | 3.95 | 30,238 | 4.98 |
| | 20° F | 16,682 | 2.52 | 20,543 | 3.11 | 26,273 | 3.72 | 30,861 | 4.38 | 37,905 | 5.50 |
| | 25° F | 18,682 | 2.63 | 22,919 | 3.26 | 29,374 | 3.89 | 34,404 | 4.60 | 42,166 | 5.77 |
| | 30° F | 20,811 | 2.74 | 25,458 | 3.41 | 32,736 | 4.05 | 38,194 | 4.82 | 46,598 | 6.03 |
| 105° F | 0° F | 8,979 | 2.11 | 11,164 | 2.56 | 14,440 | 3.09 | 17,185 | 3.60 | 21,426 | 4.57 |
| | 10° F | 11,724 | 2.37 | 14,495 | 2.90 | 18,746 | 3.47 | 22,150 | 4.07 | 27,415 | 5.14 |
| | 20° F | 14,960 | 2.62 | 18,376 | 3.24 | 23,836 | 3.85 | 28,005 | 4.55 | 34,446 | 5.72 |
| | 25° F | 16,767 | 2.75 | 20,531 | 3.42 | 26,708 | 4.04 | 31,276 | 4.79 | 38,402 | 6.01 |
| | 30° F | 18,707 | 2.88 | 22,835 | 3.59 | 29,779 | 4.23 | 34,795 | 5.03 | - | - |
| | 45° F | 25,381 | 3.26 | - | - | - | - | - | - | - | - |

1 - MCA (Minimum Circuit Ampacity) is calculated based on all concurrent loads applied to the circuit. (Largest load x 1.25 + 100% of all other loads including the control circuit.) Unit cooler amperages not included.

2 - Based on 80% full at 90°F ambient.

3 - Based on 50 ft. of equivalent refrigerant line piping. (Does not include the evaporator.)

4 - KW is for the unit.

5 - Rated in accordance with ANSI/AHRI Standard 520-2004.

6 - Operating weight reflects flooded refrigerant charge.

7 - Size based on mounted optional suction line trim.

8 - Contact factory to confirm single phase application selections.

“-” - Consult your local Century Representative.

NOTE: Compressor amps are based on the maximum cataloged suction temperature for the condensing unit. Limiting the operation to this envelope is required via a MOP expansion valve or other means.

| R448a - Medium Temp | | Model Numbers | | | |
|--|-------------------------------|----------------------|---------------------|---------------------|---------------------|
| | | BLU-B050M-8A | BLU-B060M-8A | BLU-B075M-8A | BLU-B090M-8A |
| Compressor Model Number | | 4FES-5 | 4EES-6 | 4DES-7 | 4CES-9 |
| Compressor Motor Protection | | INHERENT | | | |
| Unit MCA¹ | 208-230/1/60 V | - | - | - | - |
| | 208-230/3/60 V | 40.0 | 40.8 | 46.1 | 56.3 |
| | 460/3/60 V | 18.4 | 18.8 | 21.2 | 25.8 |
| Compressor RLA / LRA | 208-230/1/60 V | - | - | - | - |
| | 208-230/3/60 V | 29.0 | 29.6 | 33.8 | 42.0 |
| | 460/3/60 V | 13.1 | 13.4 | 15.3 | 19.0 |
| Total Number of Condenser Fan Motors | | 1 | 1 | 1 | 1 |
| Size of Motor (HP) | | 1.2 | 1.2 | 1.2 | 1.2 |
| Diameter of Blade (in.) | | ZN050.DC | ZN050.DC | ZN050.DC | ZN050.DC |
| Condenser Fan Motor Amps (each) | 208-230/1/60 V ⁸ | - | - | - | - |
| | 208-230/3/60 V | 2.8 | 2.8 | 2.8 | 2.8 |
| | 460/3/60 V | 1.55 | 1.55 | 1.55 | 1.55 |
| Receiver Size per circuit (in.) | | 8.625 x 16 | 10.75 x 18 | 10.75 x 18 | 10.75 x 18 |
| Receiver Capacity 80% Full per circuit (lbs.)² | | 23.2 | 39.2 | 39.2 | 39.2 |
| Unit Operating Charge per circuit (approx. lbs.) | Standard ³ | 17.1 | 22.7 | 22.9 | 22.9 |
| | w/ Flood Control ³ | 28.8 | 39.2 | 39.4 | 39.4 |
| Suction Connection per circuit - ODS (in.)⁷ | | 7/8 | 1 1/8 | 1 1/8 | 1 1/8 |
| Liquid Line Connection per circuit - ODS (in.) | | 5/8 | 5/8 | 7/8 | 7/8 |
| Unit Shipping Weight - Approximate (lbs.) | | 845 | 860 | 866 | 872 |
| Unit Operating Weight - Approximate (lbs.)⁶ | | 822 | 845 | 851 | 856 |

| Capacity Ratings | | | | | | | | | |
|-------------------------|----------------------|---------------------|-----------------------|---------------------|-----------------------|---------------------|-----------------------|---------------------|-----------------------|
| Ambient Temp. | Suction Temp. | BLU-B050M-8A | | BLU-B060M-8A | | BLU-B075M-8A | | BLU-B090M-8A | |
| | | Capacity | KW⁴ | Capacity | KW⁴ | Capacity | KW⁴ | Capacity | KW⁴ |
| 85° F | 0° F | 28,192 | 4.63 | 35,143 | 5.54 | 40,561 | 6.36 | 49,041 | 7.81 |
| | 10° F | 35,904 | 5.15 | 44,743 | 6.23 | 51,427 | 7.18 | 60,939 | 8.91 |
| | 20° F | 44,841 | 5.67 | 55,733 | 6.92 | 63,421 | 8.03 | 74,166 | 10.09 |
| | 25° F | 49,608 | 5.93 | 61,627 | 7.28 | 69,897 | 8.47 | 81,295 | 10.71 |
| | 30° F | 54,679 | 6.19 | 67,827 | 7.64 | 76,745 | 8.91 | 88,694 | 11.35 |
| | 45° F | 71,475 | 6.99 | 88,426 | 8.75 | 99,118 | 10.31 | - | - |
| 95° F | 0° F | 25,631 | 4.77 | 31,905 | 5.72 | 36,738 | 6.52 | 44,651 | 8.04 |
| | 10° F | 32,754 | 5.33 | 40,760 | 6.46 | 46,825 | 7.41 | 55,674 | 9.22 |
| | 20° F | 41,047 | 5.90 | 51,048 | 7.22 | 57,999 | 8.33 | 67,925 | 10.48 |
| | 25° F | 45,521 | 6.19 | 56,529 | 7.61 | 63,999 | 8.80 | - | - |
| | 30° F | 50,245 | 6.47 | 62,298 | 8.00 | 70,351 | 9.28 | - | - |
| | 45° F | - | - | - | - | - | - | - | - |
| 105° F | 0° F | 23,090 | 4.88 | 28,693 | 5.86 | 32,988 | 6.64 | 40,221 | 8.22 |
| | 10° F | 29,596 | 5.49 | 36,804 | 6.66 | 42,202 | 7.60 | - | - |
| | 20° F | 37,239 | 6.10 | 46,289 | 7.48 | - | - | - | - |
| | 25° F | - | - | - | - | - | - | - | - |
| | 30° F | - | - | - | - | - | - | - | - |
| | 45° F | - | - | - | - | - | - | - | - |

1 - MCA (Minimum Circuit Ampacity) is calculated based on all concurrent loads applied to the circuit. (Largest load x 1.25 + 100% of all other loads including the control circuit.) Unit cooler amperages not included.

2 - Based on 80% full at 90°F ambient.

3 - Based on 50 ft. of equivalent refrigerant line piping. (Does not include the evaporator.)

4 - KW is for the unit.

5 - Rated in accordance with ANSI/AHRI Standard 520-2004.

6 - Operating weight reflects flooded refrigerant charge.

7 - Size based on mounted optional suction line trim.

8 - Contact factory to confirm single phase application selections.

“-” - Consult your local Century Representative.

NOTE: Compressor amps are based on the maximum cataloged suction temperature for the condensing unit. Limiting the operation to this envelope is required via a MOP expansion valve or other means.

| R449a - Medium Temp | | Model Numbers | | | | |
|--|-------------------------------|---------------|--------------|--------------|--------------|--------------|
| | | BLU-B020M-9A | BLU-B025M-9A | BLU-B030M-9A | BLU-B035M-9A | BLU-B040M-9A |
| Compressor Model Number | | 2GES-2 | 2FES-3 | 2EES-3 | 2DES-3 | 2CES-4 |
| Compressor Motor Protection | | INHERENT | | | | |
| Unit MCA ¹ | 208-230/1/60 V | 25.1 | - | 37.6 | 38.5 | - |
| | 208-230/3/60 V | 17.4 | 19.6 | 23.3 | 25.0 | 29.2 |
| | 460/3/60 V | 8.1 | 9.2 | 11.2 | 12.2 | 13.4 |
| Compressor RLA / LRA | 208-230/1/60 V | 16.1 | - | 26.1 | 26.8 | - |
| | 208-230/3/60 V | 10.9 | 12.6 | 15.6 | 17.0 | 20.3 |
| | 460/3/60 V | 4.8 | 5.7 | 7.3 | 8.1 | 9.1 |
| Total Number of Condenser Fan Motors | | 1 | 1 | 1 | 1 | 1 |
| Size of Motor (HP) | | 1.2 | 1.2 | 1.2 | 1.2 | 1.2 |
| Diameter of Blade (in.) | | ZN050.DC | ZN050.DC | ZN050.DC | ZN050.DC | ZN050.DC |
| Condenser Fan Motor Amps (each) | 208-230/1/60 V ⁸ | 4 | - | 4 | 4 | - |
| | 208-230/3/60 V | 2.8 | 2.8 | 2.8 | 2.8 | 2.8 |
| | 460/3/60 V | 1.55 | 1.55 | 1.55 | 1.55 | 1.55 |
| Receiver Size per circuit (in.) | | 8.625 x 16 | 8.625 x 16 | 8.625 x 16 | 8.625 x 16 | 8.625 x 16 |
| Receiver Capacity 80% Full per circuit (lbs.) ² | | 23.2 | 23.2 | 23.2 | 23.2 | 23.2 |
| Unit Operating Charge per circuit (approx. lbs.) | Standard ³ | 12.8 | 12.8 | 14.3 | 14.3 | 15.3 |
| | w/ Flood Control ³ | 19.2 | 19.2 | 23.8 | 23.8 | 27 |
| Suction Connection per circuit - ODS (in.) ⁷ | | 7/8 | 7/8 | 7/8 | 7/8 | 7/8 |
| Liquid Line Connection per circuit - ODS (in.) | | 1/2 | 1/2 | 1/2 | 5/8 | 5/8 |
| Unit Shipping Weight - Approximate (lbs.) | | 721 | 727 | 797 | 797 | 805 |
| Unit Operating Weight - Approximate (lbs.) ⁶ | | 707 | 713 | 785 | 785 | 795 |

| Capacity Ratings | | Unit Model Numbers | | | | | | | | | |
|------------------|---------------|--------------------|-----------------|--------------|-----------------|--------------|-----------------|--------------|-----------------|--------------|-----------------|
| Ambient Temp. | Suction Temp. | BLU-B020M-9A | | BLU-B025M-9A | | BLU-B030M-9A | | BLU-B035M-9A | | BLU-B040M-9A | |
| | | Capacity | KW ⁴ | Capacity | KW ⁴ | Capacity | KW ⁴ | Capacity | KW ⁴ | Capacity | KW ⁴ |
| 85° F | 0° F | 11,155 | 2.03 | 13,892 | 2.45 | 17,633 | 2.97 | 20,917 | 3.43 | 25,865 | 4.33 |
| | 10° F | 14,453 | 2.23 | 17,901 | 2.73 | 22,672 | 3.27 | 26,736 | 3.81 | 32,896 | 4.79 |
| | 20° F | 18,315 | 2.42 | 22,565 | 2.99 | 28,593 | 3.57 | 33,552 | 4.20 | 41,129 | 5.26 |
| | 25° F | 20,463 | 2.52 | 25,144 | 3.12 | 31,900 | 3.72 | 37,362 | 4.39 | 45,649 | 5.50 |
| | 30° F | 22,782 | 2.60 | 27,839 | 3.25 | 35,477 | 3.86 | 41,278 | 4.59 | 50,292 | 5.74 |
| 95° F | 45° F | 30,595 | 2.85 | 36,625 | 3.62 | 47,324 | 4.29 | 54,302 | 5.19 | 65,903 | 6.46 |
| | 0° F | 10,061 | 2.07 | 12,524 | 2.50 | 15,995 | 3.04 | 19,007 | 3.52 | 23,587 | 4.46 |
| | 10° F | 13,075 | 2.30 | 16,178 | 2.81 | 20,656 | 3.38 | 24,396 | 3.95 | 30,071 | 4.98 |
| | 20° F | 16,600 | 2.52 | 20,420 | 3.11 | 26,138 | 3.72 | 30,696 | 4.38 | 37,669 | 5.50 |
| | 25° F | 18,567 | 2.63 | 22,774 | 3.26 | 29,212 | 3.89 | 34,208 | 4.60 | 41,919 | 5.76 |
| 105° F | 30° F | 20,694 | 2.74 | 25,310 | 3.41 | 32,520 | 4.05 | 37,935 | 4.82 | 46,320 | 6.03 |
| | 45° F | 27,923 | 3.05 | 33,413 | 3.86 | 43,686 | 4.54 | 50,118 | 5.50 | 60,864 | 6.84 |
| | 0° F | 8,947 | 2.11 | 11,113 | 2.56 | 14,371 | 3.09 | 17,100 | 3.60 | 21,315 | 4.57 |
| | 10° F | 11,672 | 2.37 | 14,415 | 2.90 | 18,641 | 3.47 | 22,042 | 4.07 | 27,275 | 5.14 |
| | 20° F | 14,866 | 2.62 | 18,258 | 3.24 | 23,684 | 3.85 | 27,846 | 4.54 | 34,245 | 5.71 |
| | 25° F | 16,656 | 2.75 | 20,392 | 3.42 | 26,528 | 4.04 | 31,086 | 4.79 | 38,163 | 6.00 |
| | 30° F | 18,595 | 2.88 | 22,694 | 3.59 | 29,592 | 4.22 | 34,571 | 5.03 | - | - |
| | 45° F | 25,201 | 3.25 | - | - | - | - | - | - | - | - |

1 - MCA (Minimum Circuit Ampacity) is calculated based on all concurrent loads applied to the circuit. (Largest load x 1.25 + 100% of all other loads including the control circuit.) Unit cooler amperages not included.

2 - Based on 80% full at 90°F ambient.

3 - Based on 50 ft. of equivalent refrigerant line piping. (Does not include the evaporator.)

4 - KW is for the unit.

5 - Rated in accordance with ANSI/AHRI Standard 520-2004.

6 - Operating weight reflects flooded refrigerant charge.

7 - Size based on mounted optional suction line trim.

8 - Contact factory to confirm single phase application selections.

“-” - Consult your local Century Representative.

NOTE: Compressor amps are based on the maximum cataloged suction temperature for the condensing unit. Limiting the operation to this envelope is required via a MOP expansion valve or other means.

| R449a - Medium Temp | | Model Numbers | | | |
|--|-------------------------------|----------------------|---------------------|---------------------|---------------------|
| | | BLU-B050M-9A | BLU-B060M-9A | BLU-B075M-9A | BLU-B090M-9A |
| Compressor Model Number | | 4FES-5 | 4EES-6 | 4DES-7 | 4CES-9 |
| Compressor Motor Protection | | INHERENT | | | |
| Unit MCA¹ | 208-230/1/60 V | - | - | - | - |
| | 208-230/3/60 V | 40.0 | 40.8 | 46.1 | 56.3 |
| | 460/3/60 V | 18.4 | 18.8 | 21.2 | 25.8 |
| Compressor RLA / LRA | 208-230/1/60 V | - | - | - | - |
| | 208-230/3/60 V | 29.0 | 29.6 | 33.8 | 42.0 |
| | 460/3/60 V | 13.1 | 13.4 | 15.3 | 19.0 |
| Total Number of Condenser Fan Motors | | 1 | 1 | 1 | 1 |
| Size of Motor (HP) | | 1.2 | 1.2 | 1.2 | 1.2 |
| Diameter of Blade (in.) | | ZN050.DC | ZN050.DC | ZN050.DC | ZN050.DC |
| Condenser Fan Motor Amps (each) | 208-230/1/60 V ⁸ | - | - | - | - |
| | 208-230/3/60 V | 2.8 | 2.8 | 2.8 | 2.8 |
| | 460/3/60 V | 1.55 | 1.55 | 1.55 | 1.55 |
| Receiver Size per circuit (in.) | | 8.625 x 16 | 10.75 x 18 | 10.75 x 18 | 10.75 x 18 |
| Receiver Capacity 80% Full per circuit (lbs.)² | | 23.2 | 39.2 | 39.2 | 39.2 |
| Unit Operating Charge per circuit (approx. lbs.) | Standard ³ | 17.1 | 22.7 | 22.9 | 22.9 |
| | w/ Flood Control ³ | 28.8 | 39.2 | 39.4 | 39.4 |
| Suction Connection per circuit - ODS (in.)⁷ | | 7/8 | 1 1/8 | 1 1/8 | 1 1/8 |
| Liquid Line Connection per circuit - ODS (in.) | | 5/8 | 5/8 | 7/8 | 7/8 |
| Unit Shipping Weight - Approximate (lbs.) | | 845 | 860 | 866 | 872 |
| Unit Operating Weight - Approximate (lbs.)⁶ | | 822 | 845 | 851 | 856 |

| Capacity Ratings | | | | | | | | | |
|-------------------------|----------------------|---------------------|-----------------------|---------------------|-----------------------|---------------------|-----------------------|---------------------|-----------------------|
| Ambient Temp. | Suction Temp. | BLU-B050M-9A | | BLU-B060M-9A | | BLU-B075M-9A | | BLU-B090M-9A | |
| | | Capacity | KW⁴ | Capacity | KW⁴ | Capacity | KW⁴ | Capacity | KW⁴ |
| 85° F | 0° F | 28,091 | 4.63 | 34,991 | 5.54 | 40,383 | 6.36 | 48,858 | 7.81 |
| | 10° F | 35,748 | 5.14 | 44,548 | 6.22 | 51,211 | 7.18 | 60,663 | 8.91 |
| | 20° F | 44,624 | 5.66 | 55,463 | 6.92 | 63,105 | 8.03 | 73,843 | 10.08 |
| | 25° F | 49,351 | 5.93 | 61,306 | 7.28 | 69,521 | 8.46 | 80,827 | 10.70 |
| | 30° F | 54,376 | 6.19 | 67,448 | 7.64 | 76,302 | 8.91 | 88,236 | 11.34 |
| | 45° F | 71,002 | 6.98 | 87,915 | 8.74 | 98,525 | 10.30 | - | - |
| 95° F | 0° F | 25,509 | 4.77 | 31,753 | 5.72 | 36,594 | 6.52 | 44,424 | 8.04 |
| | 10° F | 32,573 | 5.33 | 40,568 | 6.46 | 46,601 | 7.41 | 55,405 | 9.21 |
| | 20° F | 40,822 | 5.90 | 50,781 | 7.22 | 57,689 | 8.32 | 67,540 | 10.47 |
| | 25° F | 45,265 | 6.19 | 56,211 | 7.61 | 63,631 | 8.80 | - | - |
| | 30° F | 49,944 | 6.47 | 61,924 | 8.00 | 69,994 | 9.27 | - | - |
| | 45° F | - | - | - | - | - | - | - | - |
| 105° F | 0° F | 22,972 | 4.88 | 28,574 | 5.86 | 32,852 | 6.64 | 40,044 | 8.22 |
| | 10° F | 29,447 | 5.49 | 36,587 | 6.66 | 41,991 | 7.60 | - | - |
| | 20° F | 37,023 | 6.10 | 46,020 | 7.47 | - | - | - | - |
| | 25° F | - | - | - | - | - | - | - | - |
| | 30° F | - | - | - | - | - | - | - | - |
| | 45° F | - | - | - | - | - | - | - | - |

1 - MCA (Minimum Circuit Ampacity) is calculated based on all concurrent loads applied to the circuit. (Largest load x 1.25 + 100% of all other loads including the control circuit.) Unit cooler amperages not included.

2 - Based on 80% full at 90°F ambient.

3 - Based on 50 ft. of equivalent refrigerant line piping. (Does not include the evaporator.)

4 - KW is for the unit.

5 - Rated in accordance with ANSI/AHRI Standard 520-2004.

6 - Operating weight reflects flooded refrigerant charge.

7 - Size based on mounted optional suction line trim.

8 - Contact factory to confirm single phase application selections.

“-” - Consult your local Century Representative.

NOTE: Compressor amps are based on the maximum cataloged suction temperature for the condensing unit. Limiting the operation to this envelope is required via a MOP expansion valve or other means.

| R407a - Medium Temp | | Model Numbers | | | | |
|--|-------------------------------|---------------|--------------|--------------|--------------|--------------|
| | | BLU-B020M-7A | BLU-B025M-7A | BLU-B030M-7A | BLU-B035M-7A | BLU-B040M-7A |
| Compressor Model Number | | 2GES-2 | 2FES-3 | 2EES-3 | 2DES-3 | 2CES-4 |
| Compressor Motor Protection | | INHERENT | | | | |
| Unit MCA ¹ | 208-230/1/60 V | 25.1 | - | 37.6 | 38.5 | - |
| | 208-230/3/60 V | 17.4 | 19.6 | 23.3 | 25.0 | 29.2 |
| | 460/3/60 V | 8.1 | 9.2 | 11.2 | 12.2 | 13.4 |
| Compressor RLA / LRA | 208-230/1/60 V | 16.1 | - | 26.1 | 26.8 | - |
| | 208-230/3/60 V | 10.9 | 12.6 | 15.6 | 17.0 | 20.3 |
| | 460/3/60 V | 4.8 | 5.7 | 7.3 | 8.1 | 9.1 |
| Total Number of Condenser Fan Motors | | 1 | 1 | 1 | 1 | 1 |
| Size of Motor (HP) | | 1.2 | 1.2 | 1.2 | 1.2 | 1.2 |
| Diameter of Blade (in.) | | ZN050.DC | ZN050.DC | ZN050.DC | ZN050.DC | ZN050.DC |
| Condenser Fan Motor Amps (each) | 208-230/1/60 V ⁸ | 4 | - | 4 | 4 | - |
| | 208-230/3/60 V | 2.8 | 2.8 | 2.8 | 2.8 | 2.8 |
| | 460/3/60 V | 1.55 | 1.55 | 1.55 | 1.55 | 1.55 |
| Receiver Size per circuit (in.) | | 8.625 x 16 | 8.625 x 16 | 8.625 x 16 | 8.625 x 16 | 8.625 x 16 |
| Receiver Capacity 80% Full per circuit (lbs.) ² | | 23.2 | 23.2 | 23.2 | 23.2 | 23.2 |
| Unit Operating Charge per circuit (approx. lbs.) | Standard ³ | 12.8 | 12.8 | 14.3 | 14.3 | 15.3 |
| | w/ Flood Control ³ | 19.2 | 19.2 | 23.8 | 23.8 | 27 |
| Suction Connection per circuit - ODS (in.) ⁷ | | 7/8 | 7/8 | 7/8 | 7/8 | 7/8 |
| Liquid Line Connection per circuit - ODS (in.) | | 1/2 | 1/2 | 1/2 | 5/8 | 5/8 |
| Unit Shipping Weight - Approximate (lbs.) | | 721 | 727 | 797 | 797 | 805 |
| Unit Operating Weight - Approximate (lbs.) ⁶ | | 707 | 713 | 785 | 785 | 795 |

| Capacity Ratings | | Unit Model Numbers | | | | | | | | | |
|------------------|---------------|--------------------|-----------------|--------------|-----------------|--------------|-----------------|--------------|-----------------|--------------|-----------------|
| Ambient Temp. | Suction Temp. | BLU-B020M-7A | | BLU-B025M-7A | | BLU-B030M-7A | | BLU-B035M-7A | | BLU-B040M-7A | |
| | | Capacity | KW ⁴ | Capacity | KW ⁴ | Capacity | KW ⁴ | Capacity | KW ⁴ | Capacity | KW ⁴ |
| 85° F | 0° F | 12,595 | 2.11 | 15,670 | 2.57 | 16,977 | 2.88 | 20,177 | 3.31 | 25,008 | 4.18 |
| | 10° F | 16,117 | 2.33 | 19,957 | 2.86 | 22,001 | 3.18 | 25,998 | 3.70 | 32,039 | 4.65 |
| | 20° F | 20,248 | 2.55 | 24,964 | 3.17 | 27,949 | 3.49 | 32,849 | 4.09 | 40,278 | 5.12 |
| | 25° F | 22,566 | 2.66 | 27,654 | 3.32 | 31,272 | 3.64 | 36,680 | 4.28 | 44,833 | 5.36 |
| | 30° F | 25,057 | 2.78 | 30,461 | 3.48 | 34,875 | 3.79 | 40,618 | 4.48 | 49,505 | 5.61 |
| | 45° F | 33,249 | 3.12 | 39,869 | 3.98 | 46,871 | 4.23 | 53,848 | 5.10 | 65,316 | 6.35 |
| 95° F | 0° F | 11,426 | 2.17 | 14,213 | 2.65 | 15,348 | 2.94 | 18,287 | 3.40 | 22,769 | 4.30 |
| | 10° F | 14,678 | 2.42 | 18,158 | 2.97 | 19,994 | 3.28 | 23,660 | 3.82 | 29,254 | 4.82 |
| | 20° F | 18,500 | 2.67 | 22,792 | 3.31 | 25,506 | 3.63 | 29,994 | 4.26 | 36,888 | 5.35 |
| | 25° F | 20,656 | 2.80 | 25,321 | 3.49 | 28,600 | 3.80 | 33,551 | 4.48 | 41,156 | 5.61 |
| | 30° F | 22,960 | 2.93 | 27,964 | 3.66 | 31,960 | 3.97 | 37,302 | 4.70 | 45,576 | 5.88 |
| | 45° F | 30,660 | 3.33 | 36,764 | 4.21 | 43,265 | 4.48 | 49,700 | 5.39 | 60,327 | 6.72 |
| 105° F | 0° F | 10,271 | 2.22 | 12,776 | 2.71 | 13,743 | 2.99 | 16,413 | 3.46 | 20,550 | 4.40 |
| | 10° F | 13,255 | 2.50 | 16,397 | 3.07 | 17,997 | 3.37 | 21,338 | 3.93 | 26,488 | 4.97 |
| | 20° F | 16,769 | 2.78 | 20,644 | 3.44 | 23,074 | 3.75 | 27,179 | 4.41 | 33,491 | 5.55 |
| | 25° F | 18,748 | 2.92 | 23,002 | 3.63 | 25,939 | 3.94 | 30,441 | 4.65 | 37,427 | 5.84 |
| | 30° F | 20,881 | 3.07 | - | - | 29,035 | 4.13 | 33,957 | 4.90 | 41,610 | 6.14 |
| | 45° F | - | - | - | - | - | - | - | - | - | - |

1 - MCA (Minimum Circuit Ampacity) is calculated based on all concurrent loads applied to the circuit. (Largest load x 1.25 + 100% of all other loads including the control circuit.) Unit cooler amperages not included.

2 - Based on 80% full at 90°F ambient.

3 - Based on 50 ft. of equivalent refrigerant line piping. (Does not include the evaporator.)

4 - KW is for the unit.

5 - Rated in accordance with ANSI/AHRI Standard 520-2004.

6 - Operating weight reflects flooded refrigerant charge.

7 - Size based on mounted optional suction line trim.

8 - Contact factory to confirm single phase application selections.

"-" - Consult your local Century Representative.

NOTE: Compressor amps are based on the maximum cataloged suction temperature for the condensing unit. Limiting the operation to this envelope is required via a MOP expansion valve or other means.

| R407a - Medium Temp | | Model Numbers | | | |
|--|-------------------------------|----------------------|---------------------|---------------------|---------------------|
| | | BLU-B050M-7A | BLU-B060M-7A | BLU-B075M-7A | BLU-B090M-7A |
| Compressor Model Number | | 4FES-5 | 4EES-6 | 4DES-7 | 4CES-9 |
| Compressor Motor Protection | | INHERENT | | | |
| Unit MCA¹ | 208-230/1/60 V | - | - | - | - |
| | 208-230/3/60 V | 40.0 | 40.8 | 46.1 | 56.3 |
| | 460/3/60 V | 18.4 | 18.8 | 21.2 | 25.8 |
| Compressor RLA / LRA | 208-230/1/60 V | - | - | - | - |
| | 208-230/3/60 V | 29.0 | 29.6 | 33.8 | 42.0 |
| | 460/3/60 V | 13.1 | 13.4 | 15.3 | 19.0 |
| Total Number of Condenser Fan Motors | | 1 | 1 | 1 | 1 |
| Size of Motor (HP) | | 1.2 | 1.2 | 1.2 | 1.2 |
| Diameter of Blade (in.) | | ZN050.DC | ZN050.DC | ZN050.DC | ZN050.DC |
| Condenser Fan Motor Amps (each) | 208-230/1/60 V ⁸ | - | - | - | - |
| | 208-230/3/60 V | 2.8 | 2.8 | 2.8 | 2.8 |
| | 460/3/60 V | 1.55 | 1.55 | 1.55 | 1.55 |
| Receiver Size per circuit (in.) | | 8.625 x 16 | 10.75 x 18 | 10.75 x 18 | 10.75 x 18 |
| Receiver Capacity 80% Full per circuit (lbs.)² | | 23.2 | 39.2 | 39.2 | 39.2 |
| Unit Operating Charge per circuit (approx. lbs.) | Standard ³ | 17.1 | 22.7 | 22.9 | 22.9 |
| | w/ Flood Control ³ | 28.8 | 39.2 | 39.4 | 39.4 |
| Suction Connection per circuit - ODS (in.)⁷ | | 7/8 | 1 1/8 | 1 1/8 | 1 1/8 |
| Liquid Line Connection per circuit - ODS (in.) | | 5/8 | 5/8 | 7/8 | 7/8 |
| Unit Shipping Weight - Approximate (lbs.) | | 845 | 860 | 866 | 872 |
| Unit Operating Weight - Approximate (lbs.)⁶ | | 822 | 845 | 851 | 856 |

| Capacity Ratings | | | | | | | | | |
|-------------------------|----------------------|---------------------|-----------------------|---------------------|-----------------------|---------------------|-----------------------|---------------------|-----------------------|
| Ambient Temp. | Suction Temp. | BLU-B050M-7A | | BLU-B060M-7A | | BLU-B075M-7A | | BLU-B090M-7A | |
| | | Capacity | KW⁴ | Capacity | KW⁴ | Capacity | KW⁴ | Capacity | KW⁴ |
| 85° F | 0° F | 27,178 | 4.47 | 33,860 | 5.34 | 39,074 | 6.12 | 47,446 | 7.48 |
| | 10° F | 34,833 | 4.99 | 43,388 | 6.02 | 49,880 | 6.94 | 59,340 | 8.57 |
| | 20° F | 43,699 | 5.52 | 54,346 | 6.72 | 61,863 | 7.79 | 72,693 | 9.73 |
| | 25° F | 48,483 | 5.78 | 60,210 | 7.08 | 68,383 | 8.23 | 79,841 | 10.35 |
| | 30° F | 53,531 | 6.05 | 66,446 | 7.44 | 75,219 | 8.68 | 87,270 | 10.99 |
| | 45° F | 70,338 | 6.88 | 87,166 | 8.58 | 97,791 | 10.11 | - | - |
| 95° F | 0° F | 24,651 | 4.60 | 30,690 | 5.50 | 35,335 | 6.27 | 43,100 | 7.69 |
| | 10° F | 31,692 | 5.17 | 39,449 | 6.24 | 45,357 | 7.15 | 54,140 | 8.86 |
| | 20° F | 39,971 | 5.74 | 49,690 | 7.00 | 56,541 | 8.07 | 66,450 | 10.10 |
| | 25° F | 44,464 | 6.03 | 55,198 | 7.39 | 62,592 | 8.55 | - | - |
| | 30° F | 49,169 | 6.33 | 61,008 | 7.79 | 69,016 | 9.03 | - | - |
| | 45° F | 64,937 | 7.22 | - | - | - | - | - | - |
| 105° F | 0° F | 22,175 | 4.71 | 27,535 | 5.63 | 31,684 | 6.38 | 38,808 | 7.86 |
| | 10° F | 28,633 | 5.31 | 35,586 | 6.42 | 40,810 | 7.32 | - | - |
| | 20° F | 36,215 | 5.93 | 45,036 | 7.24 | - | - | - | - |
| | 25° F | 40,461 | 6.25 | - | - | - | - | - | - |
| | 30° F | - | - | - | - | - | - | - | - |
| | 45° F | - | - | - | - | - | - | - | - |

- 1 - MCA (Minimum Circuit Ampacity) is calculated based on all concurrent loads applied to the circuit. (Largest load x 1.25 + 100% of all other loads including the control circuit.) Unit cooler amperages not included.
- 2 - Based on 80% full at 90°F ambient.
- 3 - Based on 50 ft. of equivalent refrigerant line piping. (Does not include the evaporator.)
- 4 - KW is for the unit.
- 5 - Rated in accordance with ANSI/AHRI Standard 520-2004.
- 6 - Operating weight reflects flooded refrigerant charge.
- 7 - Size based on mounted optional suction line trim.
- 8 - Consult your local Century Representative.

NOTE: Compressor amps are based on the maximum cataloged suction temperature for the condensing unit. Limiting the operation to this envelope is required via a MOP expansion valve or other means.

| R407c - Medium Temp | | Model Numbers | | | | |
|--|-------------------------------|----------------------|---------------------|---------------------|---------------------|---------------------|
| | | BLU-B020M-7C | BLU-B025M-7C | BLU-B030M-7C | BLU-B035M-7C | BLU-B040M-7C |
| Compressor Model Number | | 2GES-2 | 2FES-3 | 2EES-3 | 2DES-3 | 2CES-4 |
| Compressor Motor Protection | | INHERENT | | | | |
| Unit MCA¹ | 208-230/1/60 V | 25.1 | - | 37.6 | 38.5 | - |
| | 208-230/3/60 V | 17.4 | 19.6 | 23.3 | 25.0 | 29.2 |
| | 460/3/60 V | 8.1 | 9.2 | 11.2 | 12.2 | 13.4 |
| Compressor RLA / LRA | 208-230/1/60 V | 16.1 | - | 26.1 | 26.8 | - |
| | 208-230/3/60 V | 10.9 | 12.6 | 15.6 | 17.0 | 20.3 |
| | 460/3/60 V | 4.8 | 5.7 | 7.3 | 8.1 | 9.1 |
| Total Number of Condenser Fan Motors | | 1 | 1 | 1 | 1 | 1 |
| Size of Motor (HP) | | 1.2 | 1.2 | 1.2 | 1.2 | 1.2 |
| Diameter of Blade (in.) | | ZN050.DC | ZN050.DC | ZN050.DC | ZN050.DC | ZN050.DC |
| Condenser Fan Motor Amps (each) | 208-230/1/60 V ⁸ | 4 | - | 4 | 4 | - |
| | 208-230/3/60 V | 2.8 | 2.8 | 2.8 | 2.8 | 2.8 |
| | 460/3/60 V | 1.55 | 1.55 | 1.55 | 1.55 | 1.55 |
| Receiver Size per circuit (in.) | | 8.625 x 16 | 8.625 x 16 | 8.625 x 16 | 8.625 x 16 | 8.625 x 16 |
| Receiver Capacity 80% Full per circuit (lbs.)² | | 23.2 | 23.2 | 23.2 | 23.2 | 23.2 |
| Unit Operating Charge per circuit (approx. lbs.) | Standard ³ | 12.8 | 12.8 | 14.3 | 14.3 | 15.3 |
| | w/ Flood Control ³ | 19.2 | 19.2 | 23.8 | 23.8 | 27 |
| Suction Connection per circuit - ODS (in.)⁷ | | 7/8 | 7/8 | 7/8 | 7/8 | 7/8 |
| Liquid Line Connection per circuit - ODS (in.) | | 1/2 | 1/2 | 1/2 | 5/8 | 5/8 |
| Unit Shipping Weight - Approximate (lbs.) | | 721 | 727 | 797 | 797 | 805 |
| Unit Operating Weight - Approximate (lbs.)⁶ | | 707 | 713 | 785 | 785 | 795 |

| Capacity Ratings | | Unit Model Numbers | | | | | | | | | |
|-------------------------|----------------------|---------------------------|-----------------------|---------------------|-----------------------|---------------------|-----------------------|---------------------|-----------------------|---------------------|-----------------------|
| Ambient Temp. | Suction Temp. | BLU-B020M-7C | | BLU-B025M-7C | | BLU-B030M-7C | | BLU-B035M-7C | | BLU-B040M-7C | |
| | | Capacity | KW⁴ | Capacity | KW⁴ | Capacity | KW⁴ | Capacity | KW⁴ | Capacity | KW⁴ |
| 85° F | 0° F | 11,785 | 1.99 | 14,661 | 2.40 | 16,559 | 2.82 | 19,138 | 3.22 | 24,073 | 4.04 |
| | 10° F | 15,110 | 2.18 | 18,746 | 2.65 | 21,467 | 3.10 | 24,574 | 3.57 | 30,948 | 4.47 |
| | 20° F | 19,039 | 2.38 | 23,520 | 2.93 | 27,264 | 3.40 | 30,893 | 3.94 | 38,995 | 4.92 |
| | 25° F | 21,254 | 2.48 | 26,188 | 3.07 | 30,525 | 3.54 | 34,388 | 4.12 | 43,472 | 5.16 |
| | 30° F | 23,630 | 2.58 | 28,954 | 3.22 | 34,020 | 3.69 | 38,089 | 4.32 | 48,139 | 5.40 |
| | 45° F | 31,679 | 2.91 | 38,066 | 3.70 | 45,838 | 4.16 | 50,622 | 4.93 | 63,477 | 6.17 |
| 95° F | 0° F | 10,912 | 2.06 | 13,559 | 2.48 | 15,169 | 2.89 | 17,583 | 3.31 | 22,141 | 4.16 |
| | 10° F | 14,003 | 2.27 | 17,347 | 2.77 | 19,725 | 3.21 | 22,616 | 3.70 | 28,511 | 4.64 |
| | 20° F | 17,632 | 2.50 | 21,753 | 3.08 | 25,068 | 3.54 | 28,443 | 4.11 | 35,907 | 5.14 |
| | 25° F | 19,665 | 2.61 | 24,192 | 3.24 | 28,074 | 3.70 | 31,670 | 4.32 | 40,043 | 5.40 |
| | 30° F | 21,868 | 2.73 | 26,803 | 3.40 | 31,291 | 3.87 | 35,112 | 4.53 | 44,429 | 5.66 |
| 105° F | 0° F | 10,027 | 2.12 | 12,433 | 2.56 | 13,774 | 2.95 | 15,989 | 3.39 | 20,182 | 4.26 |
| | 10° F | 12,888 | 2.36 | 15,927 | 2.88 | 17,969 | 3.30 | 20,657 | 3.81 | 26,049 | 4.78 |
| | 20° F | 16,220 | 2.61 | 19,967 | 3.21 | 22,862 | 3.66 | 26,026 | 4.26 | 32,823 | 5.33 |
| | 25° F | 18,074 | 2.74 | 22,194 | 3.39 | 25,616 | 3.84 | 28,989 | 4.49 | 36,599 | 5.61 |
| | 30° F | 20,080 | 2.88 | 24,593 | 3.57 | 28,556 | 4.03 | 32,115 | 4.72 | 40,613 | 5.90 |
| | 45° F | - | - | - | - | - | - | - | - | - | - |

1 - MCA (Minimum Circuit Ampacity) is calculated based on all concurrent loads applied to the circuit. (Largest load x 1.25 + 100% of all other loads including the control circuit.) Unit cooler amperages not included.

2 - Based on 80% full at 90°F ambient.

3 - Based on 50 ft. of equivalent refrigerant line piping. (Does not include the evaporator.)

4 - KW is for the unit.

5 - Rated in accordance with ANSI/AHRI Standard 520-2004.

6 - Operating weight reflects flooded refrigerant charge.

7 - Size based on mounted optional suction line trim.

8 - Contact factory to confirm single phase application selections.

"-" - Consult your local Century Representative.

NOTE: Compressor amps are based on the maximum cataloged suction temperature for the condensing unit. Limiting the operation to this envelope is required via a MOP expansion valve or other means.

| R407c - Medium Temp | | Model Numbers | | | |
|--|-------------------------------------|----------------------|---------------------|---------------------|---------------------|
| | | BLU-B050M-7C | BLU-B060M-7C | BLU-B075M-7C | BLU-B090M-7C |
| Compressor Model Number | | 4FES-5 | 4EES-6 | 4DES-7 | 4CES-9 |
| Compressor Motor Protection | | INHERENT | | | |
| Unit MCA¹ | 208-230/1/60 V | - | - | - | - |
| | 208-230/3/60 V | 40.0 | 40.8 | 46.1 | 56.3 |
| | 460/3/60 V | 18.4 | 18.8 | 21.2 | 25.8 |
| Compressor RLA / LRA | 208-230/1/60 V | - | - | - | - |
| | 208-230/3/60 V | 29.0 | 29.6 | 33.8 | 42.0 |
| | 460/3/60 V | 13.1 | 13.4 | 15.3 | 19.0 |
| Total Number of Condenser Fan Motors | | 1 | 1 | 1 | 1 |
| Size of Motor (HP) | | 1.2 | 1.2 | 1.2 | 1.2 |
| Diameter of Blade (in.) | | ZN050.DC | ZN050.DC | ZN050.DC | ZN050.DC |
| Condenser Fan Motor Amps (each) | 208-230/1/60 V⁸ | - | - | - | - |
| | 208-230/3/60 V | 2.8 | 2.8 | 2.8 | 2.8 |
| | 460/3/60 V | 1.55 | 1.55 | 1.55 | 1.55 |
| Receiver Size per circuit (in.) | | 8.625 x 16 | 10.75 x 18 | 10.75 x 18 | 10.75 x 18 |
| Receiver Capacity 80% Full per circuit (lbs.)² | | 23.2 | 39.2 | 39.2 | 39.2 |
| Unit Operating Charge per circuit (approx. lbs.) | Standard³ | 17.1 | 22.7 | 22.9 | 22.9 |
| | w/ Flood Control³ | 28.8 | 39.2 | 39.4 | 39.4 |
| Suction Connection per circuit - ODS (in.)⁷ | | 7/8 | 1 1/8 | 1 1/8 | 1 1/8 |
| Liquid Line Connection per circuit - ODS (in.) | | 5/8 | 5/8 | 7/8 | 7/8 |
| Unit Shipping Weight - Approximate (lbs.) | | 845 | 860 | 866 | 872 |
| Unit Operating Weight - Approximate (lbs.)⁶ | | 822 | 845 | 851 | 856 |

| Capacity Ratings | | | | | | | | | |
|-------------------------|----------------------|---------------------|-----------------------|---------------------|-----------------------|---------------------|-----------------------|---------------------|-----------------------|
| Ambient Temp. | Suction Temp. | BLU-B050M-7C | | BLU-B060M-7C | | BLU-B075M-7C | | BLU-B090M-7C | |
| | | Capacity | KW⁴ | Capacity | KW⁴ | Capacity | KW⁴ | Capacity | KW⁴ |
| 85° F | 0° F | 24,862 | 4.15 | 31,182 | 4.94 | 36,969 | 5.77 | 45,098 | 7.02 |
| | 10° F | 32,284 | 4.63 | 40,440 | 5.57 | 47,607 | 6.53 | 57,100 | 8.02 |
| | 20° F | 40,961 | 5.13 | 51,239 | 6.23 | 59,508 | 7.34 | 70,223 | 9.10 |
| | 25° F | 45,764 | 5.39 | 57,067 | 6.58 | 65,894 | 7.76 | 77,215 | 9.69 |
| | 30° F | 50,658 | 5.65 | 63,165 | 6.93 | 72,564 | 8.20 | 84,425 | 10.30 |
| | 45° F | 66,970 | 6.49 | 83,151 | 8.07 | 94,214 | 9.62 | - | - |
| 95° F | 0° F | 22,585 | 4.23 | 28,312 | 5.05 | 33,633 | 5.90 | 41,178 | 7.20 |
| | 10° F | 29,438 | 4.75 | 36,880 | 5.73 | 43,489 | 6.72 | 52,364 | 8.26 |
| | 20° F | 37,416 | 5.30 | 46,802 | 6.45 | 54,551 | 7.58 | 64,443 | 9.42 |
| | 25° F | 41,879 | 5.58 | 52,329 | 6.82 | 60,407 | 8.04 | 70,885 | 10.04 |
| | 30° F | 46,460 | 5.87 | 57,878 | 7.21 | 66,577 | 8.51 | - | - |
| | 45° F | 61,564 | 6.78 | 76,343 | 8.44 | - | - | - | - |
| 105° F | 0° F | 20,315 | 4.28 | 25,450 | 5.11 | 30,308 | 5.98 | 37,235 | 7.32 |
| | 10° F | 26,608 | 4.84 | 33,342 | 5.84 | 39,364 | 6.86 | - | - |
| | 20° F | 33,899 | 5.44 | 42,404 | 6.62 | - | - | - | - |
| | 25° F | 37,965 | 5.74 | 47,405 | 7.03 | - | - | - | - |
| | 30° F | 42,283 | 6.05 | - | - | - | - | - | - |
| | 45° F | - | - | - | - | - | - | - | - |

1 - MCA (Minimum Circuit Ampacity) is calculated based on all concurrent loads applied to the circuit. (Largest load x 1.25 + 100% of all other loads including the control circuit.) Unit cooler amperages not included.

2 - Based on 80% full at 90°F ambient.

3 - Based on 50 ft. of equivalent refrigerant line piping. (Does not include the evaporator.)

4 - KW is for the unit.

5 - Rated in accordance with ANSI/AHRI Standard 520-2004.

6 - Operating weight reflects flooded refrigerant charge.

7 - Size based on mounted optional suction line trim.

8 - Contact factory to confirm single phase application selections.

“-” - Consult your local Century Representative.

NOTE: Compressor amps are based on the maximum cataloged suction temperature for the condensing unit. Limiting the operation to this envelope is required via a MOP expansion valve or other means.

| R407f - Medium Temp | | Model Numbers | | | | |
|--|-------------------------------|----------------------|---------------------|---------------------|---------------------|---------------------|
| | | BLU-B020M-7F | BLU-B025M-7F | BLU-B030M-7F | BLU-B035M-7F | BLU-B040M-7F |
| Compressor Model Number | | 2GES-2 | 2FES-3 | 2EES-3 | 2DES-3 | 2CES-4 |
| Compressor Motor Protection | | INHERENT | | | | |
| Unit MCA¹ | 208-230/1/60 V | 25.1 | - | 37.6 | 38.5 | - |
| | 208-230/3/60 V | 17.4 | 19.6 | 23.3 | 25.0 | 29.2 |
| | 460/3/60 V | 8.1 | 9.2 | 11.2 | 12.2 | 13.4 |
| Compressor RLA / LRA | 208-230/1/60 V | 16.1 | - | 26.1 | 26.8 | - |
| | 208-230/3/60 V | 10.9 | 12.6 | 15.6 | 17.0 | 20.3 |
| | 460/3/60 V | 4.8 | 5.7 | 7.3 | 8.1 | 9.1 |
| Total Number of Condenser Fan Motors | | 1 | 1 | 1 | 1 | 1 |
| Size of Motor (HP) | | 1.2 | 1.2 | 1.2 | 1.2 | 1.2 |
| Diameter of Blade (in.) | | ZN050.DC | ZN050.DC | ZN050.DC | ZN050.DC | ZN050.DC |
| Condenser Fan Motor Amps (each) | 208-230/1/60 V ⁸ | 4 | - | 4 | 4 | - |
| | 208-230/3/60 V | 2.8 | 2.8 | 2.8 | 2.8 | 2.8 |
| | 460/3/60 V | 1.55 | 1.55 | 1.55 | 1.55 | 1.55 |
| Receiver Size per circuit (in.) | | 8.625 x 16 | 8.625 x 16 | 8.625 x 16 | 8.625 x 16 | 8.625 x 16 |
| Receiver Capacity 80% Full per circuit (lbs.)² | | 23.2 | 23.2 | 23.2 | 23.2 | 23.2 |
| Unit Operating Charge per circuit (approx. lbs.) | Standard ³ | 12.8 | 12.8 | 14.3 | 14.3 | 15.3 |
| | w/ Flood Control ³ | 19.2 | 19.2 | 23.8 | 23.8 | 27 |
| Suction Connection per circuit - ODS (in.)⁷ | | 7/8 | 7/8 | 7/8 | 7/8 | 7/8 |
| Liquid Line Connection per circuit - ODS (in.) | | 1/2 | 1/2 | 1/2 | 5/8 | 5/8 |
| Unit Shipping Weight - Approximate (lbs.) | | 721 | 727 | 797 | 797 | 805 |
| Unit Operating Weight - Approximate (lbs.)⁶ | | 707 | 713 | 785 | 785 | 795 |

| Capacity Ratings | | Unit Model Numbers | | | | | | | | | |
|-------------------------|----------------------|---------------------------|-----------------------|---------------------|-----------------------|---------------------|-----------------------|---------------------|-----------------------|---------------------|-----------------------|
| Ambient Temp. | Suction Temp. | BLU-B020M-7F | | BLU-B025M-7F | | BLU-B030M-7F | | BLU-B035M-7F | | BLU-B040M-7F | |
| | | Capacity | KW⁴ | Capacity | KW⁴ | Capacity | KW⁴ | Capacity | KW⁴ | Capacity | KW⁴ |
| 85° F | 0° F | 12,701 | 2.10 | 15,832 | 2.56 | 18,069 | 3.01 | 21,462 | 3.48 | 26,562 | 4.39 |
| | 10° F | 16,290 | 2.33 | 20,233 | 2.87 | 23,359 | 3.34 | 27,602 | 3.89 | 33,983 | 4.89 |
| | 20° F | 20,528 | 2.56 | 25,369 | 3.18 | 29,611 | 3.66 | 34,800 | 4.31 | 42,671 | 5.41 |
| | 25° F | 22,901 | 2.67 | 28,114 | 3.35 | 33,122 | 3.83 | 38,750 | 4.53 | 47,314 | 5.67 |
| | 30° F | 25,456 | 2.79 | 31,032 | 3.52 | 36,904 | 3.99 | 42,847 | 4.75 | 52,264 | 5.94 |
| | 45° F | 33,883 | 3.17 | 40,781 | 4.05 | 49,288 | 4.49 | 56,645 | 5.44 | 68,715 | 6.79 |
| 95° F | 0° F | 11,637 | 2.18 | 14,501 | 2.65 | 16,431 | 3.08 | 19,540 | 3.57 | 24,296 | 4.52 |
| | 10° F | 14,976 | 2.43 | 18,583 | 2.99 | 21,346 | 3.45 | 25,251 | 4.03 | 31,176 | 5.08 |
| | 20° F | 18,923 | 2.69 | 23,366 | 3.35 | 27,164 | 3.82 | 31,934 | 4.51 | 39,274 | 5.65 |
| | 25° F | 21,142 | 2.83 | 25,981 | 3.53 | 30,445 | 4.00 | 35,695 | 4.75 | 43,658 | 5.95 |
| | 30° F | 23,520 | 2.96 | 28,717 | 3.72 | 33,962 | 4.19 | 39,538 | 4.99 | 48,298 | 6.24 |
| | 45° F | 31,475 | 3.40 | 37,845 | 4.31 | 45,693 | 4.75 | 52,465 | 5.77 | 63,749 | 7.18 |
| 105° F | 0° F | 10,572 | 2.24 | 13,182 | 2.73 | 14,789 | 3.13 | 17,632 | 3.65 | 22,033 | 4.63 |
| | 10° F | 13,660 | 2.52 | 16,935 | 3.10 | 19,330 | 3.54 | 22,900 | 4.15 | 28,372 | 5.24 |
| | 20° F | 17,318 | 2.81 | 21,365 | 3.49 | 24,736 | 3.95 | 29,093 | 4.67 | 35,844 | 5.87 |
| | 25° F | 19,370 | 2.97 | 23,842 | 3.69 | 27,770 | 4.16 | 32,560 | 4.94 | 40,033 | 6.19 |
| | 30° F | 21,598 | 3.12 | - | - | 31,045 | 4.37 | 36,218 | 5.21 | - | - |
| | 45° F | - | - | - | - | - | - | - | - | - | - |

1 - MCA (Minimum Circuit Ampacity) is calculated based on all concurrent loads applied to the circuit. (Largest load x 1.25 + 100% of all other loads including the control circuit.) Unit cooler amperages not included.

2 - Based on 80% full at 90°F ambient.

3 - Based on 50 ft. of equivalent refrigerant line piping. (Does not include the evaporator.)

4 - KW is for the unit.

5 - Rated in accordance with ANSI/AHRI Standard 520-2004.

6 - Operating weight reflects flooded refrigerant charge.

7 - Size based on mounted optional suction line trim.

8 - Contact factory to confirm single phase application selections.

"-" - Consult your local Century Representative.

NOTE: Compressor amps are based on the maximum cataloged suction temperature for the condensing unit. Limiting the operation to this envelope is required via a MOP expansion valve or other means.

| R407f - Medium Temp | | Model Numbers | | | |
|--|-------------------------------------|----------------------|---------------------|---------------------|---------------------|
| | | BLU-B050M-7F | BLU-B060M-7F | BLU-B075M-7F | BLU-B090M-7F |
| Compressor Model Number | | 4FES-5 | 4EES-6 | 4DES-7 | 4CES-9 |
| Compressor Motor Protection | | INHERENT | | | |
| Unit MCA¹ | 208-230/1/60 V | - | - | - | - |
| | 208-230/3/60 V | 40.0 | 40.8 | 46.1 | 56.3 |
| | 460/3/60 V | 18.4 | 18.8 | 21.2 | 25.8 |
| Compressor RLA / LRA | 208-230/1/60 V | - | - | - | - |
| | 208-230/3/60 V | 29.0 | 29.6 | 33.8 | 42.0 |
| | 460/3/60 V | 13.1 | 13.4 | 15.3 | 19.0 |
| Total Number of Condenser Fan Motors | | 1 | 1 | 1 | 1 |
| Size of Motor (HP) | | 1.2 | 1.2 | 1.2 | 1.2 |
| Diameter of Blade (in.) | | ZN050.DC | ZN050.DC | ZN050.DC | ZN050.DC |
| Condenser Fan Motor Amps (each) | 208-230/1/60 V⁸ | - | - | - | - |
| | 208-230/3/60 V | 2.8 | 2.8 | 2.8 | 2.8 |
| | 460/3/60 V | 1.55 | 1.55 | 1.55 | 1.55 |
| Receiver Size per circuit (in.) | | 8.625 x 16 | 10.75 x 18 | 10.75 x 18 | 10.75 x 18 |
| Receiver Capacity 80% Full per circuit (lbs.)² | | 23.2 | 39.2 | 39.2 | 39.2 |
| Unit Operating Charge per circuit (approx. lbs.) | Standard³ | 17.1 | 22.9 | 22.9 | 22.9 |
| | w/ Flood Control⁵ | 28.8 | 39.4 | 39.4 | 39.4 |
| Suction Connection per circuit - ODS (in.)⁷ | | 7/8 | 1 1/8 | 1 1/8 | 1 1/8 |
| Liquid Line Connection per circuit - ODS (in.) | | 5/8 | 5/8 | 7/8 | 7/8 |
| Unit Shipping Weight - Approximate (lbs.) | | 845 | 860 | 866 | 872 |
| Unit Operating Weight - Approximate (lbs.)⁶ | | 822 | 845 | 851 | 856 |

| Capacity Ratings | | | | | | | | | |
|-------------------------|----------------------|---------------------|-----------------------|---------------------|-----------------------|---------------------|-----------------------|---------------------|-----------------------|
| Ambient Temp. | Suction Temp. | BLU-B050M-7F | | BLU-B060M-7F | | BLU-B075M-7F | | BLU-B090M-7F | |
| | | Capacity | KW⁴ | Capacity | KW⁴ | Capacity | KW⁴ | Capacity | KW⁴ |
| 85° F | 0° F | 28,837 | 4.69 | 35,941 | 5.62 | 41,461 | 6.46 | 50,176 | 7.93 |
| | 10° F | 36,924 | 5.25 | 46,014 | 6.36 | 52,744 | 7.34 | 62,667 | 9.11 |
| | 20° F | 46,172 | 5.82 | 57,395 | 7.12 | 65,317 | 8.27 | 76,556 | 10.40 |
| | 25° F | 51,165 | 6.11 | 63,574 | 7.52 | 72,128 | 8.75 | 84,025 | 11.09 |
| | 30° F | 56,482 | 6.41 | 70,086 | 7.92 | 79,344 | 9.25 | 91,880 | 11.80 |
| | 45° F | 74,094 | 7.33 | 91,799 | 9.19 | 102,949 | 10.85 | - | - |
| 95° F | 0° F | 26,263 | 4.84 | 32,685 | 5.80 | 37,676 | 6.62 | 45,839 | 8.16 |
| | 10° F | 33,763 | 5.44 | 42,014 | 6.60 | 48,238 | 7.57 | 57,398 | 9.43 |
| | 20° F | 42,453 | 6.06 | 52,700 | 7.43 | 59,942 | 8.57 | 70,323 | 10.80 |
| | 25° F | 47,120 | 6.38 | 58,469 | 7.86 | 66,289 | 9.10 | - | - |
| | 30° F | 52,098 | 6.70 | 64,617 | 8.29 | 73,021 | 9.63 | - | - |
| | 45° F | - | - | - | - | - | - | - | - |
| 105° F | 0° F | 23,731 | 4.95 | 29,483 | 5.94 | 33,902 | 6.74 | 41,482 | 8.35 |
| | 10° F | 30,621 | 5.60 | 38,076 | 6.80 | 43,652 | 7.76 | - | - |
| | 20° F | 38,719 | 6.27 | 48,065 | 7.69 | - | - | - | - |
| | 25° F | - | - | - | - | - | - | - | - |
| | 30° F | - | - | - | - | - | - | - | - |
| | 45° F | - | - | - | - | - | - | - | - |

- 1 - MCA (Minimum Circuit Ampacity) is calculated based on all concurrent loads applied to the circuit. (Largest load x 1.25 + 100% of all other loads including the control circuit.) Unit cooler amperages not included.
- 2 - Based on 80% full at 90°F ambient.
- 3 - Based on 50 ft. of equivalent refrigerant line piping. (Does not include the evaporator.)
- 4 - KW is for the unit.
- 5 - Rated in accordance with ANSI/AHRI Standard 520-2004.
- 6 - Operating weight reflects flooded refrigerant charge.
- 7 - Size based on mounted optional suction line trim.
- 8 - Contact factory to confirm single phase application selections.
- “-” - Consult your local Century Representative.

NOTE: Compressor amps are based on the maximum cataloged suction temperature for the condensing unit. Limiting the operation to this envelope is required via a MOP expansion valve or other means.

| R-404a - Low Temp | | Model Numbers | | |
|--|-------------------------------|----------------------|--------------------|--------------------|
| | | BLU-B030L-4 | BLU-B035L-4 | BLU-B040L-4 |
| Compressor Model Number | | 2DES-2 | 4FES-3 | 4EES-4 |
| Compressor Motor Protection | | INHERENT | | |
| Unit MCA¹ | 208-230/1/60 V | - | - | - |
| | 208-230/3/60 V | 20.2 | 26.2 | 29.2 |
| | 460/3/60 V | 10.1 | 12.2 | 13.5 |
| Compressor RLA / LRA | 208-230/1/60 V | - | - | - |
| | 208-230/3/60 V | 13.1 | 17.9 | 20.3 |
| | 460/3/60 V | 6.4 | 8.1 | 9.2 |
| Total Number of Condenser Fan Motors | | 1 | 1 | 1 |
| Size of Motor (HP) | | 1.2 | 1.2 | 1.2 |
| Diameter of Blade (in.) | | ZN050.DC | ZN050.DC | ZN050.DC |
| Condenser Fan Motor Amps (each) | 208-230/1/60 V ⁸ | - | - | - |
| | 208-230/3/60 V | 2.8 | 2.8 | 2.8 |
| | 460/3/60 V | 1.6 | 1.6 | 1.6 |
| Receiver Size per circuit (in.) | | 8.625 x 16 | 8.625 x 16 | 8.625 x 16 |
| Receiver Capacity 80% Full per circuit (lbs.)² | | 23.2 | 23.2 | 23.2 |
| Unit Operating Charge per circuit (approx. lbs.) | Standard ³ | 12.8 | 14.3 | 15.3 |
| | w/ Flood Control ³ | 18.8 | 23.1 | 26.3 |
| Suction Connection per circuit - ODS (in.)⁷ | | 7/8 | 7/8 | 7/8 |
| Liquid Line Connection per circuit - ODS (in.) | | 0.5 | 0.5 | 0.5 |
| Unit Shipping Weight - Approximate (lbs.) | | 779 | 827 | 839 |
| Unit Operating Weight - Approximate (lbs.)⁶ | | 765 | 815 | 829 |

| Capacity Ratings | | Unit Model Numbers | | | | | |
|-------------------------|----------------------|---------------------------|-----------------------|--------------------|-----------------------|--------------------|-----------------------|
| Ambient Temp. | Suction Temp. | BLU-B030L-4 | | BLU-B035L-4 | | BLU-B040L-4 | |
| | | Capacity | KW⁴ | Capacity | KW⁴ | Capacity | KW⁴ |
| 85° F | 0° F | 22,734 | 4.09 | 30,154 | 5.19 | 37,471 | 6.40 |
| | -10° F | 18,237 | 3.68 | 24,249 | 4.66 | 30,240 | 5.68 |
| | -20° F | 14,240 | 3.28 | 19,051 | 4.16 | 23,857 | 4.99 |
| | -25° F | 12,420 | 3.09 | 16,738 | 3.91 | 20,997 | 4.66 |
| | -30° F | 10,711 | 2.90 | 14,583 | 3.67 | 18,317 | 4.35 |
| | -40° F | 7,564 | 2.55 | 10,736 | 3.22 | 13,532 | 3.75 |
| 95° F | 0° | 20,396 | 4.19 | 27,192 | 5.35 | 33,745 | 6.60 |
| | -10° F | 16,353 | 3.74 | 21,910 | 4.79 | 27,245 | 5.83 |
| | -20° F | 12,724 | 3.32 | 17,230 | 4.24 | 21,488 | 5.10 |
| | -25° F | 11,063 | 3.11 | 15,135 | 3.98 | 18,900 | 4.74 |
| | -30° F | 9,498 | 2.92 | 13,184 | 3.72 | 16,462 | 4.40 |
| | -40° F | 6,586 | 2.54 | 9,623 | 3.24 | 12,076 | 3.76 |
| 105° F | 0° F | 18,030 | 4.26 | 24,180 | 5.47 | 29,954 | 6.76 |
| | -10° F | 14,444 | 3.78 | 19,490 | 4.87 | 24,227 | 5.94 |
| | -20° F | 11,185 | 3.33 | 15,356 | 4.30 | 19,098 | 5.16 |
| | -25° F | 9,701 | 3.11 | 13,481 | 4.02 | 16,783 | 4.79 |
| | -30° F | 8,247 | 2.90 | 11,708 | 3.75 | 14,590 | 4.43 |
| | -40° F | 5,610 | 2.50 | 8,461 | 3.23 | 10,601 | 3.75 |

1 - MCA (Minimum Circuit Ampacity) is calculated based on all concurrent loads applied to the circuit. (Largest load x 1.25 + 100% of all other loads including the control circuit.) Unit cooler amperages not included.

2 - Based on 80% full at 90°F ambient.

3 - Based on 50 ft. of equivalent refrigerant line piping. (Does not include the evaporator.)

4 - KW is for the unit.

5 - Rated in accordance with ANSI/AHRI Standard 520-2004.

6 - Operating weight reflects flooded refrigerant charge.

7 - Size based on mounted optional suction line trim.

8 - Contact factory to confirm single phase application selections.

“-” - Consult your local Century Representative.

NOTE: Compressor amps are based on the maximum cataloged suction temperature for the condensing unit. Limiting the operation to this envelope is required via a MOP expansion valve or other means.

| R-404a - Low Temp | | Model Numbers | | | |
|--|-------------------------------|---------------|-------------|-------------|-------------|
| | | BLU-B050L-4 | BLU-B060L-4 | BLU-B075L-4 | BLU-B100L-4 |
| Compressor Model Number | | 4DES-5 | 4VE(S)-7 | 4TE(S)-9 | 4NE(S)-14 |
| Compressor Motor Protection | | INHERENT | | | |
| Unit MCA ¹ | 208-230/1/60 V | - | - | - | - |
| | 208-230/3/60 V | 33.7 | 37.5 | 47.2 | 58.8 |
| | 460/3/60 V | 15.6 | 17.3 | 21.7 | 26.9 |
| Compressor RLA / LRA | 208-230/1/60 V | - | - | - | - |
| | 208-230/3/60 V | 23.9 | 27.0 | 34.7 | 44.0 |
| | 460/3/60 V | 10.8 | 12.2 | 15.7 | 19.9 |
| Total Number of Condenser Fan Motors | | 1 | 1 | 1 | 1 |
| Size of Motor (HP) | | 1.2 | 1.2 | 1.2 | 1.2 |
| Diameter of Blade (in.) | | ZN050.DC | ZN050.DC | ZN050.DC | ZN050.DC |
| Condenser Fan Motor Amps (each) | 208-230/1/60 V ⁸ | - | - | - | - |
| | 208-230/3/60 V | 2.8 | 2.8 | 2.8 | 2.8 |
| | 460/3/60 V | 1.6 | 1.6 | 1.6 | 1.6 |
| Receiver Size per circuit (in.) | | 10.75 x 18 | 10.75 x 18 | 10.75 x 18 | 10.75 x 18 |
| Receiver Capacity 80% Full per circuit (lbs.) ² | | 39.2 | 39.2 | 39.2 | 39.2 |
| Unit Operating Charge per circuit (approx. lbs.) | Standard ³ | 20.9 | 20.9 | 22.7 | 23.2 |
| | w/ Flood Control ³ | 36.8 | 36.8 | 38.6 | 39.1 |
| Suction Connection per circuit - ODS (in.) ⁷ | | 7/8 | 1 1/8 | 1 1/8 | 1 3/8 |
| Liquid Line Connection per circuit - ODS (in.) | | 0.5 | 0.5 | 0.625 | 0.625 |
| Unit Shipping Weight - Approximate (lbs.) | | 858 | 968 | 958 | 999 |
| Unit Operating Weight - Approximate (lbs.) ⁶ | | 848 | 960 | 950 | 987 |

| Capacity Ratings | | Unit Model Numbers | | | | | | | |
|------------------|---------------|--------------------|-----------------|-------------|-----------------|-------------|-----------------|-------------|-----------------|
| Ambient Temp. | Suction Temp. | BLU-B050L-4 | | BLU-B060L-4 | | BLU-B075L-4 | | BLU-B100L-4 | |
| | | Capacity | KW ⁴ | Capacity | KW ⁴ | Capacity | KW ⁴ | Capacity | KW ⁴ |
| 85° F | 0° F | 44,758 | 7.38 | 52,132 | 8.56 | 60,184 | 10.51 | 72,619 | 14.01 |
| | -10° F | 36,160 | 6.54 | 41,888 | 7.36 | 49,108 | 9.02 | 60,377 | 11.97 |
| | -20° F | 28,542 | 5.74 | 32,665 | 6.27 | 38,900 | 7.67 | 48,663 | 10.10 |
| | -25° F | 25,076 | 5.36 | 28,474 | 5.76 | 34,209 | 7.04 | 43,164 | 9.24 |
| | -30° F | 21,885 | 4.99 | 24,562 | 5.28 | 29,802 | 6.45 | 37,857 | 8.42 |
| | -40° F | 16,175 | 4.29 | 17,535 | 4.40 | 21,786 | 5.38 | 28,059 | 6.93 |
| 95° F | 0° | 40,380 | 7.62 | 46,582 | 8.78 | 53,752 | 10.77 | - | - |
| | -10° F | 32,608 | 6.72 | 37,297 | 7.50 | 43,756 | 9.20 | 53,425 | 12.00 |
| | -20° F | 25,677 | 5.86 | 28,928 | 6.33 | 34,619 | 7.76 | 42,992 | 10.06 |
| | -25° F | 22,585 | 5.45 | 25,119 | 5.79 | 30,334 | 7.11 | 38,033 | 9.17 |
| | -30° F | 19,677 | 5.06 | 21,560 | 5.28 | 26,342 | 6.48 | 33,277 | 8.32 |
| | -40° F | 14,429 | 4.31 | 15,096 | 4.35 | 19,031 | 5.36 | 24,389 | 6.77 |
| 105° F | 0° F | 35,951 | 7.82 | 41,128 | 8.98 | - | - | - | - |
| | -10° F | 29,015 | 6.86 | 32,745 | 7.62 | 38,512 | 9.34 | - | - |
| | -20° F | 22,843 | 5.95 | 25,275 | 6.38 | 30,336 | 7.84 | 37,382 | 9.94 |
| | -25° F | 20,042 | 5.52 | 21,846 | 5.81 | 26,550 | 7.15 | 33,028 | 9.02 |
| | -30° F | 17,449 | 5.10 | 18,635 | 5.27 | 22,931 | 6.50 | 28,765 | 8.13 |
| | -40° F | 12,685 | 4.31 | 12,756 | 4.29 | 16,356 | 5.32 | 20,806 | 6.53 |

- 1 - MCA (Minimum Circuit Ampacity) is calculated based on all concurrent loads applied to the circuit. (Largest load x 1.25 + 100% of all other loads including the control circuit.) Unit cooler amperages not included.
- 2 - Based on 80% full at 90°F ambient.
- 3 - Based on 50 ft. of equivalent refrigerant line piping. (Does not include the evaporator.)
- 4 - KW is for the unit.
- 5 - Rated in accordance with ANSI/AHRI Standard 520-2004.
- 6 - Operating weight reflects flooded refrigerant charge.
- 7 - Size based on mounted optional suction line trim.
- 8 - " - Consult your local Century Representative.

NOTE: Compressor amps are based on the maximum cataloged suction temperature for the condensing unit. Limiting the operation to this envelope is required via a MOP expansion valve or other means.

| R-507 - Low Temp | | Model Numbers | | |
|--|-------------------------------|----------------------|--------------------|--------------------|
| | | BLU-B030L-7 | BLU-B035L-7 | BLU-B040L-7 |
| Compressor Model Number | | 2DES-2 | 4FES-3 | 4EES-4 |
| Compressor Motor Protection | | INHERENT | | |
| Unit MCA¹ | 208-230/1/60 V | - | - | - |
| | 208-230/3/60 V | 20.2 | 26.2 | 29.2 |
| | 460/3/60 V | 10.1 | 12.2 | 13.5 |
| Compressor RLA / LRA | 208-230/1/60 V | - | - | - |
| | 208-230/3/60 V | 13.1 | 17.9 | 20.3 |
| | 460/3/60 V | 6.4 | 8.1 | 9.2 |
| Total Number of Condenser Fan Motors | | 1 | 1 | 1 |
| Size of Motor (HP) | | 1.2 | 1.2 | 1.2 |
| Diameter of Blade (in.) | | ZN050.DC | ZN050.DC | ZN050.DC |
| Condenser Fan Motor Amps (each) | 208-230/1/60 V ⁸ | - | - | - |
| | 208-230/3/60 V | 2.8 | 2.8 | 2.8 |
| | 460/3/60 V | 1.6 | 1.6 | 1.6 |
| Receiver Size per circuit (in.) | | 8.625 x 16 | 8.625 x 16 | 8.625 x 16 |
| Receiver Capacity 80% Full per circuit (lbs.)² | | 23.2 | 23.2 | 23.2 |
| Unit Operating Charge per circuit (approx. lbs.) | Standard ³ | 12.8 | 14.3 | 15.3 |
| | w/ Flood Control ³ | 18.8 | 23.1 | 26.3 |
| Suction Connection per circuit - ODS (in.)⁷ | | 7/8 | 7/8 | 7/8 |
| Liquid Line Connection per circuit - ODS (in.) | | 0.5 | 0.5 | 0.5 |
| Unit Shipping Weight - Approximate (lbs.) | | 779 | 827 | 839 |
| Unit Operating Weight - Approximate (lbs.)⁶ | | 765 | 815 | 829 |

| Capacity Ratings | | Unit Model Numbers | | | | | |
|-------------------------|----------------------|---------------------------|-----------------------|--------------------|-----------------------|--------------------|-----------------------|
| Ambient Temp. | Suction Temp. | BLU-B030L-7 | | BLU-B035L-7 | | BLU-B040L-7 | |
| | | Capacity | KW⁴ | Capacity | KW⁴ | Capacity | KW⁴ |
| 85° F | 0° F | 23,358 | 4.09 | 30,984 | 5.19 | 38,341 | 6.38 |
| | -10° F | 18,848 | 3.68 | 25,028 | 4.67 | 31,113 | 5.66 |
| | -20° F | 14,798 | 3.28 | 19,776 | 4.16 | 24,670 | 4.97 |
| | -25° F | 12,946 | 3.09 | 17,417 | 3.91 | 21,726 | 4.64 |
| | -30° F | 11,204 | 2.90 | 15,213 | 3.67 | 18,978 | 4.33 |
| | -40° F | 7,991 | 2.55 | 11,279 | 3.22 | 14,049 | 3.73 |
| 95° F | 0° | 20,931 | 4.19 | 27,899 | 5.35 | 34,506 | 6.58 |
| | -10° F | 16,875 | 3.75 | 22,594 | 4.79 | 28,021 | 5.81 |
| | -20° F | 13,213 | 3.32 | 17,864 | 4.24 | 22,234 | 5.07 |
| | -25° F | 11,545 | 3.11 | 15,737 | 3.98 | 19,566 | 4.72 |
| | -30° F | 9,951 | 2.92 | 13,749 | 3.73 | 17,079 | 4.38 |
| | -40° F | 6,984 | 2.54 | 10,120 | 3.24 | 12,506 | 3.74 |
| 105° F | 0° F | 18,463 | 4.26 | 24,707 | 5.47 | 30,575 | 6.74 |
| | -10° F | 14,864 | 3.79 | 20,061 | 4.88 | 24,880 | 5.92 |
| | -20° F | 11,614 | 3.33 | 15,884 | 4.30 | 19,758 | 5.14 |
| | -25° F | 10,102 | 3.11 | 13,992 | 4.02 | 17,372 | 4.77 |
| | -30° F | 8,652 | 2.90 | 12,221 | 3.75 | 15,131 | 4.41 |
| | -40° F | 5,967 | 2.50 | 8,903 | 3.23 | 10,941 | 3.73 |

1 - MCA (Minimum Circuit Ampacity) is calculated based on all concurrent loads applied to the circuit. (Largest load x 1.25 + 100% of all other loads including the control circuit.) Unit cooler amperages not included.

2 - Based on 80% full at 90°F ambient.

3 - Based on 50 ft. of equivalent refrigerant line piping. (Does not include the evaporator.)

4 - KW is for the unit.

5 - Rated in accordance with ANSI/AHRI Standard 520-2004.

6 - Operating weight reflects flooded refrigerant charge.

7 - Size based on mounted optional suction line trim.

8 - Contact factory to confirm single phase application selections.

"-" - Consult your local Century Representative.

NOTE: Compressor amps are based on the maximum cataloged suction temperature for the condensing unit. Limiting the operation to this envelope is required via a MOP expansion valve or other means.

| R-507 - Low Temp | | Model Numbers | | | |
|--|-------------------------------|----------------------|--------------------|--------------------|--------------------|
| | | BLU-B050L-7 | BLU-B060L-7 | BLU-B075L-7 | BLU-B100L-7 |
| Compressor Model Number | | 4DES-5 | 4VE(S)-7 | 4TE(S)-9 | 4NE(S)-14 |
| Compressor Motor Protection | | INHERENT | | | |
| Unit MCA¹ | 208-230/1/60 V | - | - | - | - |
| | 208-230/3/60 V | 33.7 | 37.5 | 47.2 | 58.8 |
| | 460/3/60 V | 15.6 | 17.3 | 21.7 | 26.9 |
| Compressor RLA / LRA | 208-230/1/60 V | - | - | - | - |
| | 208-230/3/60 V | 23.9 | 27.0 | 34.7 | 44.0 |
| | 460/3/60 V | 10.8 | 12.2 | 15.7 | 19.9 |
| Total Number of Condenser Fan Motors | | 1 | 1 | 1 | 1 |
| Size of Motor (HP) | | 1.2 | 1.2 | 1.2 | 1.2 |
| Diameter of Blade (in.) | | ZN050.DC | ZN050.DC | ZN050.DC | ZN050.DC |
| Condenser Fan Motor Amps (each) | 208-230/1/60 V ⁸ | - | - | - | - |
| | 208-230/3/60 V | 2.8 | 2.8 | 2.8 | 2.8 |
| | 460/3/60 V | 1.6 | 1.6 | 1.6 | 1.6 |
| Receiver Size per circuit (in.) | | 10.75 x 18 | 10.75 x 18 | 10.75 x 18 | 10.75 x 18 |
| Receiver Capacity 80% Full per circuit (lbs.)² | | 39.2 | 39.2 | 39.2 | 39.2 |
| Unit Operating Charge per circuit (approx. lbs.) | Standard ³ | 20.9 | 20.9 | 22.7 | 23.2 |
| | w/ Flood Control ³ | 36.8 | 36.8 | 38.6 | 39.1 |
| Suction Connection per circuit - ODS (in.)⁷ | | 7/8 | 1 1/8 | 1 1/8 | 1 3/8 |
| Liquid Line Connection per circuit - ODS (in.) | | 0.5 | 0.5 | 0.625 | 0.625 |
| Unit Shipping Weight - Approximate (lbs.) | | 858 | 968 | 958 | 999 |
| Unit Operating Weight - Approximate (lbs.)⁶ | | 848 | 960 | 950 | 987 |

| Capacity Ratings | | Unit Model Numbers | | | | | | | |
|-------------------------|----------------------|---------------------------|-----------------------|--------------------|-----------------------|--------------------|-----------------------|--------------------|-----------------------|
| Ambient Temp. | Suction Temp. | BLU-B050L-7 | | BLU-B060L-7 | | BLU-B075L-7 | | BLU-B100L-7 | |
| | | Capacity | KW⁴ | Capacity | KW⁴ | Capacity | KW⁴ | Capacity | KW⁴ |
| 85° F | 0° F | 45,855 | 7.36 | 53,370 | 8.54 | 61,513 | 10.48 | 74,016 | 13.96 |
| | -10° F | 37,209 | 6.52 | 43,124 | 7.33 | 50,454 | 8.99 | 61,977 | 11.92 |
| | -20° F | 29,487 | 5.72 | 33,846 | 6.24 | 40,234 | 7.63 | 50,263 | 10.06 |
| | -25° F | 25,978 | 5.33 | 29,570 | 5.73 | 35,502 | 7.00 | 44,669 | 9.19 |
| | -30° F | 22,699 | 4.96 | 25,557 | 5.25 | 30,936 | 6.41 | 39,267 | 8.37 |
| | -40° F | 16,797 | 4.27 | 18,310 | 4.36 | 22,674 | 5.34 | 29,050 | 6.89 |
| 95° F | 0° | 41,292 | 7.60 | 47,643 | 8.75 | 54,832 | 10.74 | - | - |
| | -10° F | 33,539 | 6.69 | 38,380 | 7.47 | 45,024 | 9.16 | 54,831 | 11.95 |
| | -20° F | 26,576 | 5.84 | 30,016 | 6.30 | 35,827 | 7.73 | 44,483 | 10.02 |
| | -25° F | 23,392 | 5.43 | 26,141 | 5.76 | 31,523 | 7.07 | 39,449 | 9.12 |
| | -30° F | 20,427 | 5.03 | 22,490 | 5.25 | 27,425 | 6.45 | 34,603 | 8.27 |
| | -40° F | 14,958 | 4.29 | 15,801 | 4.31 | 19,821 | 5.32 | 25,264 | 6.73 |
| 105° F | 0° F | 36,686 | 7.79 | 41,881 | 8.95 | - | - | - | - |
| | -10° F | 29,792 | 6.84 | 33,679 | 7.59 | 39,507 | 9.31 | - | - |
| | -20° F | 23,640 | 5.93 | 26,235 | 6.36 | 31,418 | 7.81 | 38,722 | 9.90 |
| | -25° F | 20,789 | 5.49 | 22,764 | 5.78 | 27,551 | 7.12 | 34,260 | 8.97 |
| | -30° F | 18,121 | 5.08 | 19,478 | 5.24 | 23,892 | 6.47 | 29,930 | 8.09 |
| | -40° F | 13,129 | 4.29 | 13,380 | 4.26 | 17,037 | 5.29 | 21,518 | 6.49 |

1 - MCA (Minimum Circuit Ampacity) is calculated based on all concurrent loads applied to the circuit. (Largest load x 1.25 + 100% of all other loads including the control circuit.) Unit cooler amperages not included.

2 - Based on 80% full at 90°F ambient.

3 - Based on 50 ft. of equivalent refrigerant line piping. (Does not include the evaporator.)

4 - KW is for the unit.

5 - Rated in accordance with ANSI/AHRI Standard 520-2004.

6 - Operating weight reflects flooded refrigerant charge.

7 - Size based on mounted optional suction line trim.

8 - Contact factory to confirm single phase application selections.

“-” - Consult your local Century Representative.

NOTE: Compressor amps are based on the maximum cataloged suction temperature for the condensing unit. Limiting the operation to this envelope is required via a MOP expansion valve or other means.

| R-448a - Low Temp | | Model Numbers | | |
|--|-------------------------------|----------------------|---------------------|---------------------|
| | | BLU-B030L-8A | BLU-B035L-8A | BLU-B040L-8A |
| Compressor Model Number | | 2DES-2 | 4FES-3 | 4EES-4 |
| Compressor Motor Protection | | INHERENT | | |
| Unit MCA¹ | 208-230/1/60 V | - | - | - |
| | 208-230/3/60 V | 20.2 | 26.2 | 29.2 |
| | 460/3/60 V | 10.1 | 12.2 | 13.5 |
| Compressor RLA / LRA | 208-230/1/60 V | - | - | - |
| | 208-230/3/60 V | 13.1 | 17.9 | 20.3 |
| | 460/3/60 V | 6.4 | 8.1 | 9.2 |
| Total Number of Condenser Fan Motors | | 1 | 1 | 1 |
| Size of Motor (HP) | | 1.2 | 1.2 | 1.2 |
| Diameter of Blade (in.) | | ZN050.DC | ZN050.DC | ZN050.DC |
| Condenser Fan Motor Amps (each) | 208-230/1/60 V ⁸ | - | - | - |
| | 208-230/3/60 V | 2.8 | 2.8 | 2.8 |
| | 460/3/60 V | 1.6 | 1.6 | 1.6 |
| Receiver Size per circuit (in.) | | 8.625 x 16 | 8.625 x 16 | 8.625 x 16 |
| Receiver Capacity 80% Full per circuit (lbs.)² | | 23.2 | 23.2 | 23.2 |
| Unit Operating Charge per circuit (approx. lbs.) | Standard ³ | 12.8 | 14.3 | 15.3 |
| | w/ Flood Control ³ | 18.8 | 23.1 | 26.3 |
| Suction Connection per circuit - ODS (in.)⁷ | | 7/8 | 7/8 | 7/8 |
| Liquid Line Connection per circuit - ODS (in.) | | 0.5 | 0.5 | 0.5 |
| Unit Shipping Weight - Approximate (lbs.) | | 779 | 827 | 839 |
| Unit Operating Weight - Approximate (lbs.)⁶ | | 765 | 815 | 829 |

| Capacity Ratings | | Unit Model Numbers | | | | | |
|-------------------------|----------------------|---------------------------|-----------------------|---------------------|-----------------------|---------------------|-----------------------|
| Ambient Temp. | Suction Temp. | BLU-B030L-8A | | BLU-B035L-8A | | BLU-B040L-8A | |
| | | Capacity | KW⁴ | Capacity | KW⁴ | Capacity | KW⁴ |
| 85° F | 0° F | 20,281 | 3.74 | 27,466 | 4.68 | 33,810 | 5.63 |
| | -10° F | 15,633 | 3.32 | 21,262 | 4.13 | 26,231 | 4.90 |
| | -20° F | 11,680 | 2.92 | 15,976 | 3.62 | 19,753 | 4.22 |
| | -25° F | 9,917 | 2.73 | 13,633 | 3.37 | 16,861 | 3.90 |
| | -30° F | 8,317 | 2.55 | 11,487 | 3.13 | 14,209 | 3.59 |
| | -40° F | 5,521 | 2.20 | 7,771 | 2.69 | 9,577 | 3.02 |
| 95° F | 0° | 18,414 | 3.83 | 24,956 | 4.82 | 30,679 | 5.80 |
| | -10° F | 14,122 | 3.37 | 19,218 | 4.23 | 23,678 | 5.01 |
| | -20° F | 10,435 | 2.94 | 14,332 | 3.67 | 17,701 | 4.28 |
| | -25° F | 8,810 | 2.73 | 12,168 | 3.40 | 15,021 | 3.93 |
| | -30° F | 7,325 | 2.53 | 10,193 | 3.15 | 12,571 | 3.60 |
| | -40° F | 4,732 | 2.16 | 6,755 | 2.68 | 8,300 | 3.00 |
| 105° F | 0° F | 16,575 | 3.90 | 22,506 | 4.94 | 27,627 | 5.93 |
| | -10° F | 12,600 | 3.40 | 17,206 | 4.30 | 21,169 | 5.09 |
| | -20° F | 9,206 | 2.93 | 12,710 | 3.70 | 15,674 | 4.30 |
| | -25° F | 7,716 | 2.71 | 10,737 | 3.41 | 13,228 | 3.94 |
| | -30° F | 6,351 | 2.50 | 8,934 | 3.14 | 10,992 | 3.59 |
| | -40° F | 3,950 | 2.10 | 5,772 | 2.65 | 7,069 | 2.95 |

1 - MCA (Minimum Circuit Ampacity) is calculated based on all concurrent loads applied to the circuit. (Largest load x 1.25 + 100% of all other loads including the control circuit.) Unit cooler amperages not included.

2 - Based on 80% full at 90°F ambient.

3 - Based on 50 ft. of equivalent refrigerant line piping. (Does not include the evaporator.)

4 - KW is for the unit.

5 - Rated in accordance with ANSI/AHRI Standard 520-2004.

6 - Operating weight reflects flooded refrigerant charge.

7 - Size based on mounted optional suction line trim.

8 - Contact factory to confirm single phase application selections.

"-" - Consult your local Century Representative.

NOTE: Compressor amps are based on the maximum cataloged suction temperature for the condensing unit. Limiting the operation to this envelope is required via a MOP expansion valve or other means.

| R-448a - Low Temp | | Model Numbers | | | |
|--|-------------------------------|----------------------|---------------------|---------------------|---------------------|
| | | BLU-B050L-8A | BLU-B060L-8A | BLU-B075L-8A | BLU-B100L-8A |
| Compressor Model Number | | 4DES-5 | 4VE(S)-7 | 4TE(S)-9 | 4NE(S)-14 |
| Compressor Motor Protection | | INHERENT | | | |
| Unit MCA¹ | 208-230/1/60 V | - | - | - | - |
| | 208-230/3/60 V | 33.7 | 37.5 | 47.2 | 58.8 |
| | 460/3/60 V | 15.6 | 17.3 | 21.7 | 26.9 |
| Compressor RLA / LRA | 208-230/1/60 V | - | - | - | - |
| | 208-230/3/60 V | 23.9 | 27.0 | 34.7 | 44.0 |
| | 460/3/60 V | 10.8 | 12.2 | 15.7 | 19.9 |
| Total Number of Condenser Fan Motors | | 1 | 1 | 1 | 1 |
| Size of Motor (HP) | | 1.2 | 1.2 | 1.2 | 1.2 |
| Diameter of Blade (in.) | | ZN050.DC | ZN050.DC | ZN050.DC | ZN050.DC |
| Condenser Fan Motor Amps (each) | 208-230/1/60 V ⁸ | - | - | - | - |
| | 208-230/3/60 V | 2.8 | 2.8 | 2.8 | 2.8 |
| | 460/3/60 V | 1.6 | 1.6 | 1.6 | 1.6 |
| Receiver Size per circuit (in.) | | 10.75 x 18 | 10.75 x 18 | 10.75 x 18 | 10.75 x 18 |
| Receiver Capacity 80% Full per circuit (lbs.)² | | 39.2 | 39.2 | 39.2 | 39.2 |
| Unit Operating Charge per circuit (approx. lbs.) | Standard ³ | 20.9 | 20.9 | 22.7 | 23.2 |
| | w/ Flood Control ³ | 36.8 | 36.8 | 38.6 | 39.1 |
| Suction Connection per circuit - ODS (in.)⁷ | | 7/8 | 1 1/8 | 1 1/8 | 1 3/8 |
| Liquid Line Connection per circuit - ODS (in.) | | 0.5 | 0.5 | 0.625 | 0.625 |
| Unit Shipping Weight - Approximate (lbs.) | | 858 | 968 | 958 | 999 |
| Unit Operating Weight - Approximate (lbs.)⁶ | | 848 | 960 | 950 | 987 |

| Capacity Ratings | | Unit Model Numbers | | | | | | | |
|-------------------------|----------------------|---------------------------|-----------------------|---------------------|-----------------------|---------------------|-----------------------|---------------------|-----------------------|
| Ambient Temp. | Suction Temp. | BLU-B050L-8A | | BLU-B060L-8A | | BLU-B075L-8A | | BLU-B100L-8A | |
| | | Capacity | KW⁴ | Capacity | KW⁴ | Capacity | KW⁴ | Capacity | KW⁴ |
| 85° F | 0° F | 39,788 | 6.41 | 47,944 | 7.69 | 56,402 | 9.35 | 69,769 | 12.37 |
| | -10° F | 30,829 | 5.58 | 37,044 | 6.58 | 44,309 | 7.96 | 55,856 | 10.36 |
| | -20° F | 23,150 | 4.81 | 27,583 | 5.53 | 33,586 | 6.66 | 43,073 | 8.51 |
| | -25° F | 19,730 | 4.44 | 23,392 | 5.03 | 28,815 | 6.04 | 37,197 | 7.65 |
| | -30° F | 16,605 | 4.08 | 19,511 | 4.54 | 24,347 | 5.44 | 31,675 | 6.81 |
| | -40° F | 11,137 | 3.42 | 12,670 | 3.61 | 16,404 | 4.31 | 21,666 | 5.26 |
| 95° F | 0° | 36,114 | 6.58 | 43,237 | 7.83 | 51,068 | 9.54 | - | - |
| | -10° F | 27,798 | 5.68 | 33,155 | 6.64 | 39,881 | 8.05 | 50,002 | 10.41 |
| | -20° F | 20,709 | 4.84 | 24,438 | 5.50 | 29,989 | 6.66 | 38,283 | 8.45 |
| | -25° F | 17,545 | 4.44 | 20,553 | 4.95 | 25,579 | 5.99 | 32,889 | 7.52 |
| | -30° F | 14,659 | 4.06 | 16,945 | 4.42 | 21,463 | 5.35 | 27,789 | 6.64 |
| 105° F | -40° F | 9,621 | 3.36 | 10,595 | 3.41 | 14,036 | 4.13 | 18,449 | 4.98 |
| | 0° F | 32,496 | 6.71 | 38,657 | 7.91 | - | - | - | - |
| | -10° F | 24,822 | 5.74 | 29,328 | 6.64 | 35,484 | 8.09 | - | - |
| | -20° F | 18,298 | 4.84 | 21,341 | 5.41 | 26,459 | 6.60 | 33,482 | 8.31 |
| | -25° F | 15,418 | 4.41 | 17,745 | 4.83 | 22,402 | 5.89 | 28,580 | 7.33 |
| | -30° F | 12,786 | 4.01 | 14,420 | 4.26 | 18,587 | 5.20 | 23,915 | 6.40 |
| -40° F | 8,159 | 3.26 | 8,559 | 3.18 | 11,693 | 3.90 | 15,226 | 4.63 | |

1 - MCA (Minimum Circuit Ampacity) is calculated based on all concurrent loads applied to the circuit. (Largest load x 1.25 + 100% of all other loads including the control circuit.) Unit cooler amperages not included.

2 - Based on 80% full at 90°F ambient.

3 - Based on 50 ft. of equivalent refrigerant line piping. (Does not include the evaporator.)

4 - KW is for the unit.

5 - Rated in accordance with ANSI/AHRI Standard 520-2004.

6 - Operating weight reflects flooded refrigerant charge.

7 - Size based on mounted optional suction line trim.

8 - Contact factory to confirm single phase application selections.

“-” - Consult your local Century Representative.

NOTE: Compressor amps are based on the maximum cataloged suction temperature for the condensing unit. Limiting the operation to this envelope is required via a MOP expansion valve or other means.

| R-449a - Low Temp | | Model Numbers | | |
|--|-------------------------------|----------------------|---------------------|---------------------|
| | | BLU-B030L-9A | BLU-B035L-9A | BLU-B040L-9A |
| Compressor Model Number | | 2DES-2 | 4FES-3 | 4EES-4 |
| Compressor Motor Protection | | INHERENT | | |
| Unit MCA¹ | 208-230/1/60 V | - | - | - |
| | 208-230/3/60 V | 20.2 | 26.2 | 29.2 |
| | 460/3/60 V | 10.1 | 12.2 | 13.5 |
| Compressor RLA / LRA | 208-230/1/60 V | - | - | - |
| | 208-230/3/60 V | 13.1 | 17.9 | 20.3 |
| | 460/3/60 V | 6.4 | 8.1 | 9.2 |
| Total Number of Condenser Fan Motors | | 1 | 1 | 1 |
| Size of Motor (HP) | | 1.2 | 1.2 | 1.2 |
| Diameter of Blade (in.) | | ZN050.DC | ZN050.DC | ZN050.DC |
| Condenser Fan Motor Amps (each) | 208-230/1/60 V ⁸ | - | - | - |
| | 208-230/3/60 V | 2.8 | 2.8 | 2.8 |
| | 460/3/60 V | 1.6 | 1.6 | 1.6 |
| Receiver Size per circuit (in.) | | 8.625 x 16 | 8.625 x 16 | 8.625 x 16 |
| Receiver Capacity 80% Full per circuit (lbs.)² | | 23.2 | 23.2 | 23.2 |
| Unit Operating Charge per circuit (approx. lbs.) | Standard ³ | 12.8 | 14.3 | 15.3 |
| | w/ Flood Control ³ | 18.8 | 23.1 | 26.3 |
| Suction Connection per circuit - ODS (in.)⁷ | | 7/8 | 7/8 | 7/8 |
| Liquid Line Connection per circuit - ODS (in.) | | 0.5 | 0.5 | 0.5 |
| Unit Shipping Weight - Approximate (lbs.) | | 779 | 827 | 839 |
| Unit Operating Weight - Approximate (lbs.)⁶ | | 765 | 815 | 829 |

| Capacity Ratings | | Unit Model Numbers | | | | | |
|-------------------------|----------------------|---------------------------|-----------------------|---------------------|-----------------------|---------------------|-----------------------|
| Ambient Temp. | Suction Temp. | BLU-B030L-9A | | BLU-B035L-9A | | BLU-B040L-9A | |
| | | Capacity | KW⁴ | Capacity | KW⁴ | Capacity | KW⁴ |
| 85° F | 0° F | 20,194 | 3.74 | 27,346 | 4.68 | 33,661 | 5.63 |
| | -10° F | 15,596 | 3.32 | 21,188 | 4.13 | 26,139 | 4.90 |
| | -20° F | 11,654 | 2.92 | 15,950 | 3.62 | 19,704 | 4.22 |
| | -25° F | 9,901 | 2.73 | 13,608 | 3.37 | 16,846 | 3.90 |
| | -30° F | 8,310 | 2.55 | 11,473 | 3.13 | 14,193 | 3.59 |
| | -40° F | 5,529 | 2.20 | 7,768 | 2.69 | 9,585 | 3.02 |
| 95° F | 0° | 18,348 | 3.83 | 24,836 | 4.82 | 30,564 | 5.80 |
| | -10° F | 14,069 | 3.37 | 19,143 | 4.23 | 23,586 | 5.01 |
| | -20° F | 10,408 | 2.94 | 14,292 | 3.67 | 17,652 | 4.28 |
| | -25° F | 8,793 | 2.73 | 12,141 | 3.40 | 14,989 | 3.93 |
| | -30° F | 7,326 | 2.53 | 10,179 | 3.15 | 12,553 | 3.60 |
| | -40° F | 4,739 | 2.16 | 6,750 | 2.68 | 8,307 | 3.00 |
| 105° F | 0° F | 16,491 | 3.90 | 22,389 | 4.94 | 27,517 | 5.93 |
| | -10° F | 12,566 | 3.40 | 17,155 | 4.30 | 21,081 | 5.09 |
| | -20° F | 9,181 | 2.93 | 12,672 | 3.70 | 15,627 | 4.30 |
| | -25° F | 7,701 | 2.71 | 10,712 | 3.41 | 13,198 | 3.94 |
| | -30° F | 6,345 | 2.50 | 8,920 | 3.14 | 10,976 | 3.59 |
| | -40° F | 3,957 | 2.10 | 5,776 | 2.65 | 7,074 | 2.95 |

1 - MCA (Minimum Circuit Ampacity) is calculated based on all concurrent loads applied to the circuit. (Largest load x 1.25 + 100% of all other loads including the control circuit.) Unit cooler amperages not included.

2 - Based on 80% full at 90°F ambient.

3 - Based on 50 ft. of equivalent refrigerant line piping. (Does not include the evaporator.)

4 - KW is for the unit.

5 - Rated in accordance with ANSI/AHRI Standard 520-2004.

6 - Operating weight reflects flooded refrigerant charge.

7 - Size based on mounted optional suction line trim.

8 - Contact factory to confirm single phase application selections.

“-” - Consult your local Century Representative.

NOTE: Compressor amps are based on the maximum cataloged suction temperature for the condensing unit. Limiting the operation to this envelope is required via a MOP expansion valve or other means.

| R-449a - Low Temp | | Model Numbers | | | |
|--|-------------------------------|----------------------|---------------------|---------------------|---------------------|
| | | BLU-B050L-9A | BLU-B060L-9A | BLU-B075L-9A | BLU-B100L-9A |
| Compressor Model Number | | 4DES-5 | 4VE(S)-7 | 4TE(S)-9 | 4NE(S)-14 |
| Compressor Motor Protection | | INHERENT | | | |
| Unit MCA ¹ | 208-230/1/60 V | - | - | - | - |
| | 208-230/3/60 V | 33.7 | 37.5 | 47.2 | 58.8 |
| | 460/3/60 V | 15.6 | 17.3 | 21.7 | 26.9 |
| Compressor RLA / LRA | 208-230/1/60 V | - | - | - | - |
| | 208-230/3/60 V | 23.9 | 27.0 | 34.7 | 44.0 |
| | 460/3/60 V | 10.8 | 12.2 | 15.7 | 19.9 |
| Total Number of Condenser Fan Motors | | 1 | 1 | 1 | 1 |
| Size of Motor (HP) | | 1.2 | 1.2 | 1.2 | 1.2 |
| Diameter of Blade (in.) | | ZN050.DC | ZN050.DC | ZN050.DC | ZN050.DC |
| Condenser Fan Motor Amps (each) | 208-230/1/60 V ⁸ | - | - | - | - |
| | 208-230/3/60 V | 2.8 | 2.8 | 2.8 | 2.8 |
| | 460/3/60 V | 1.6 | 1.6 | 1.6 | 1.6 |
| Receiver Size per circuit (in.) | | 10.75 x 18 | 10.75 x 18 | 10.75 x 18 | 10.75 x 18 |
| Receiver Capacity 80% Full per circuit (lbs.) ² | | 39.2 | 39.2 | 39.2 | 39.2 |
| Unit Operating Charge per circuit (approx. lbs.) | Standard ³ | 20.9 | 20.9 | 22.7 | 23.2 |
| | w/ Flood Control ³ | 36.8 | 36.8 | 38.6 | 39.1 |
| Suction Connection per circuit - ODS (in.) ⁷ | | 7/8 | 1 1/8 | 1 1/8 | 1 3/8 |
| Liquid Line Connection per circuit - ODS (in.) | | 0.5 | 0.5 | 0.625 | 0.625 |
| Unit Shipping Weight - Approximate (lbs.) | | 858 | 968 | 958 | 999 |
| Unit Operating Weight - Approximate (lbs.) ⁶ | | 848 | 960 | 950 | 987 |

| Capacity Ratings | | Unit Model Numbers | | | | | | | |
|-------------------------|---------------|---------------------------|-----------------|--------------|-----------------|--------------|-----------------|--------------|-----------------|
| Ambient Temp. | Suction Temp. | BLU-B050L-9A | | BLU-B060L-9A | | BLU-B075L-9A | | BLU-B100L-9A | |
| | | Capacity | KW ⁴ | Capacity | KW ⁴ | Capacity | KW ⁴ | Capacity | KW ⁴ |
| 85° F | 0° F | 39,654 | 6.41 | 47,738 | 7.69 | 56,202 | 9.35 | 69,517 | 12.37 |
| | -10° F | 30,722 | 5.58 | 36,923 | 6.58 | 44,149 | 7.96 | 55,645 | 10.36 |
| | -20° F | 23,094 | 4.81 | 27,527 | 5.53 | 33,543 | 6.66 | 43,018 | 8.51 |
| | -25° F | 19,695 | 4.44 | 23,362 | 5.03 | 28,763 | 6.04 | 37,176 | 7.65 |
| | -30° F | 16,587 | 4.08 | 19,503 | 4.54 | 24,354 | 5.44 | 31,639 | 6.81 |
| | -40° F | 11,149 | 3.42 | 12,697 | 3.61 | 16,421 | 4.31 | 21,686 | 5.26 |
| 95° F | 0° | 35,981 | 6.58 | 43,090 | 7.83 | 50,815 | 9.54 | - | - |
| | -10° F | 27,692 | 5.68 | 33,039 | 6.64 | 39,727 | 8.05 | 49,807 | 10.41 |
| | -20° F | 20,653 | 4.84 | 24,385 | 5.50 | 29,949 | 6.66 | 38,181 | 8.45 |
| | -25° F | 17,509 | 4.44 | 20,525 | 4.95 | 25,528 | 5.99 | 32,824 | 7.52 |
| | -30° F | 14,640 | 4.06 | 16,938 | 4.42 | 21,438 | 5.35 | 27,757 | 6.64 |
| | -40° F | 9,630 | 3.36 | 10,621 | 3.41 | 14,051 | 4.13 | 18,468 | 4.98 |
| 105° F | 0° F | 32,330 | 6.71 | 38,471 | 7.91 | - | - | - | - |
| | -10° F | 24,752 | 5.74 | 29,265 | 6.64 | 35,342 | 8.09 | - | - |
| | -20° F | 18,246 | 4.84 | 21,295 | 5.41 | 26,388 | 6.60 | 33,453 | 8.31 |
| | -25° F | 15,384 | 4.41 | 17,723 | 4.83 | 22,358 | 5.89 | 28,529 | 7.33 |
| | -30° F | 12,769 | 4.01 | 14,417 | 4.26 | 18,566 | 5.20 | 23,892 | 6.40 |
| | -40° F | 8,167 | 3.26 | 8,586 | 3.18 | 11,708 | 3.90 | 15,247 | 4.63 |

1 - MCA (Minimum Circuit Ampacity) is calculated based on all concurrent loads applied to the circuit. (Largest load x 1.25 + 100% of all other loads including the control circuit.) Unit cooler amperages not included.

2 - Based on 80% full at 90°F ambient.

3 - Based on 50 ft. of equivalent refrigerant line piping. (Does not include the evaporator.)

4 - KW is for the unit.

5 - Rated in accordance with ANSI/AHRI Standard 520-2004.

6 - Operating weight reflects flooded refrigerant charge.

7 - Size based on mounted optional suction line trim.

8 - Contact factory to confirm single phase application selections.

“-” - Consult your local Century Representative.

NOTE: Compressor amps are based on the maximum cataloged suction temperature for the condensing unit. Limiting the operation to this envelope is required via a MOP expansion valve or other means.

| R-407a - Low Temp | | Model Numbers | | |
|--|-------------------------------|----------------------|---------------------|---------------------|
| | | BLU-B030L-7A | BLU-B035L-7A | BLU-B040L-7A |
| Compressor Model Number | | 2DES-2 | 4FES-3 | 4EES-4 |
| Compressor Motor Protection | | INHERENT | | |
| Unit MCA¹ | 208-230/1/60 V | - | - | - |
| | 208-230/3/60 V | 20.2 | 26.2 | 29.2 |
| | 460/3/60 V | 10.1 | 12.2 | 13.5 |
| Compressor RLA / LRA | 208-230/1/60 V | - | - | - |
| | 208-230/3/60 V | 13.1 | 17.9 | 20.3 |
| | 460/3/60 V | 6.4 | 8.1 | 9.2 |
| Total Number of Condenser Fan Motors | | 1 | 1 | 1 |
| Size of Motor (HP) | | 1.2 | 1.2 | 1.2 |
| Diameter of Blade (in.) | | ZN050.DC | ZN050.DC | ZN050.DC |
| Condenser Fan Motor Amps (each) | 208-230/1/60 V ⁸ | - | - | - |
| | 208-230/3/60 V | 2.8 | 2.8 | 2.8 |
| | 460/3/60 V | 1.6 | 1.6 | 1.6 |
| Receiver Size per circuit (in.) | | 8.625 x 16 | 8.625 x 16 | 8.625 x 16 |
| Receiver Capacity 80% Full per circuit (lbs.)² | | 23.2 | 23.2 | 23.2 |
| Unit Operating Charge per circuit (approx. lbs.) | Standard ³ | 12.8 | 14.3 | 15.3 |
| | w/ Flood Control ³ | 18.8 | 23.1 | 26.3 |
| Suction Connection per circuit - ODS (in.)⁷ | | 7/8 | 7/8 | 7/8 |
| Liquid Line Connection per circuit - ODS (in.) | | 0.5 | 0.5 | 0.5 |
| Unit Shipping Weight - Approximate (lbs.) | | 779 | 827 | 839 |
| Unit Operating Weight - Approximate (lbs.)⁶ | | 765 | 815 | 829 |

| Capacity Ratings | | Unit Model Numbers | | | | | |
|-------------------------|----------------------|---------------------------|-----------------------|---------------------|-----------------------|---------------------|-----------------------|
| Ambient Temp. | Suction Temp. | BLU-B030L-7A | | BLU-B035L-7A | | BLU-B040L-7A | |
| | | Capacity | KW⁴ | Capacity | KW⁴ | Capacity | KW⁴ |
| 85° F | 0° F | 19,494 | 3.60 | 26,933 | 4.59 | 32,598 | 5.40 |
| | -10° F | 14,906 | 3.19 | 20,771 | 4.05 | 25,086 | 4.69 |
| | -20° F | 11,004 | 2.81 | 15,559 | 3.54 | 18,691 | 4.03 |
| | -25° F | 9,280 | 2.62 | 13,253 | 3.31 | 15,865 | 3.72 |
| | -30° F | 7,712 | 2.44 | 11,143 | 3.08 | 13,259 | 3.42 |
| | -40° F | 4,992 | 2.12 | 7,492 | 2.66 | 8,752 | 2.88 |
| 95° F | 0° | 17,648 | 3.69 | 24,514 | 4.73 | 29,532 | 5.56 |
| | -10° F | 13,403 | 3.24 | 18,817 | 4.15 | 22,597 | 4.79 |
| | -20° F | 9,786 | 2.82 | 14,001 | 3.61 | 16,681 | 4.08 |
| | -25° F | 8,203 | 2.62 | 11,870 | 3.35 | 14,071 | 3.74 |
| | -30° F | 6,760 | 2.43 | 9,918 | 3.10 | 11,680 | 3.42 |
| | -40° F | 4,248 | 2.08 | 6,539 | 2.66 | 7,519 | 2.85 |
| 105° F | 0° F | 15,846 | 3.75 | 22,135 | 4.86 | 26,553 | 5.68 |
| | -10° F | 11,922 | 3.27 | 16,898 | 4.23 | 20,158 | 4.86 |
| | -20° F | 8,601 | 2.81 | 12,465 | 3.65 | 14,731 | 4.10 |
| | -25° F | 7,146 | 2.60 | 10,509 | 3.38 | 12,341 | 3.74 |
| | -30° F | 5,828 | 2.39 | 8,736 | 3.12 | 10,148 | 3.41 |
| | -40° F | 3,515 | 2.02 | 5,624 | 2.65 | 6,328 | 2.81 |

1 - MCA (Minimum Circuit Ampacity) is calculated based on all concurrent loads applied to the circuit. (Largest load x 1.25 + 100% of all other loads including the control circuit.) Unit cooler amperages not included.

2 - Based on 80% full at 90°F ambient.

3 - Based on 50 ft. of equivalent refrigerant line piping. (Does not include the evaporator.)

4 - KW is for the unit.

5 - Rated in accordance with ANSI/AHRI Standard 520-2004.

6 - Operating weight reflects flooded refrigerant charge.

7 - Size based on mounted optional suction line trim.

8 - Contact factory to confirm single phase application selections.

"-" - Consult your local Century Representative.

NOTE: Compressor amps are based on the maximum cataloged suction temperature for the condensing unit. Limiting the operation to this envelope is required via a MOP expansion valve or other means.

| R-407a - Low Temp | | Model Numbers | | | |
|--|-------------------------------|----------------------|---------------------|---------------------|---------------------|
| | | BLU-B050L-7A | BLU-B060L-7A | BLU-B075L-7A | BLU-B100L-7A |
| Compressor Model Number | | 4DES-5 | 4VE(S)-7 | 4TE(S)-9 | 4NE(S)-14 |
| Compressor Motor Protection | | INHERENT | | | |
| Unit MCA¹ | 208-230/1/60 V | - | - | - | - |
| | 208-230/3/60 V | 33.7 | 37.5 | 47.2 | 58.8 |
| | 460/3/60 V | 15.6 | 17.3 | 21.7 | 26.9 |
| Compressor RLA / LRA | 208-230/1/60 V | - | - | - | - |
| | 208-230/3/60 V | 23.9 | 27.0 | 34.7 | 44.0 |
| | 460/3/60 V | 10.8 | 12.2 | 15.7 | 19.9 |
| Total Number of Condenser Fan Motors | | 1 | 1 | 1 | 1 |
| Size of Motor (HP) | | 1.2 | 1.2 | 1.2 | 1.2 |
| Diameter of Blade (in.) | | ZN050.DC | ZN050.DC | ZN050.DC | ZN050.DC |
| Condenser Fan Motor Amps (each) | 208-230/1/60 V ⁸ | - | - | - | - |
| | 208-230/3/60 V | 2.8 | 2.8 | 2.8 | 2.8 |
| | 460/3/60 V | 1.6 | 1.6 | 1.6 | 1.6 |
| Receiver Size per circuit (in.) | | 10.75 x 18 | 10.75 x 18 | 10.75 x 18 | 10.75 x 18 |
| Receiver Capacity 80% Full per circuit (lbs.)² | | 39.2 | 39.2 | 39.2 | 39.2 |
| Unit Operating Charge per circuit (approx. lbs.) | Standard ³ | 20.9 | 20.9 | 22.7 | 23.2 |
| | w/ Flood Control ³ | 36.8 | 36.8 | 38.6 | 39.1 |
| Suction Connection per circuit - ODS (in.)⁷ | | 7/8 | 1 1/8 | 1 1/8 | 1 3/8 |
| Liquid Line Connection per circuit - ODS (in.) | | 0.5 | 0.5 | 0.625 | 0.625 |
| Unit Shipping Weight - Approximate (lbs.) | | 858 | 968 | 958 | 999 |
| Unit Operating Weight - Approximate (lbs.)⁶ | | 848 | 960 | 950 | 987 |

| Capacity Ratings | | Unit Model Numbers | | | | | | | |
|-------------------------|----------------------|---------------------------|-----------------------|---------------------|-----------------------|---------------------|-----------------------|---------------------|-----------------------|
| Ambient Temp. | Suction Temp. | BLU-B050L-7A | | BLU-B060L-7A | | BLU-B075L-7A | | BLU-B100L-7A | |
| | | Capacity | KW⁴ | Capacity | KW⁴ | Capacity | KW⁴ | Capacity | KW⁴ |
| 85° F | 0° F | 38,382 | 6.15 | 46,310 | 7.26 | 55,229 | 8.98 | 68,257 | 11.86 |
| | -10° F | 29,464 | 5.34 | 35,444 | 6.19 | 43,086 | 7.64 | 53,978 | 9.93 |
| | -20° F | 21,887 | 4.58 | 26,028 | 5.20 | 32,337 | 6.41 | 40,950 | 8.19 |
| | -25° F | 18,547 | 4.22 | 21,825 | 4.73 | 27,480 | 5.84 | 34,960 | 7.40 |
| | -30° F | 15,477 | 3.88 | 17,956 | 4.28 | 22,984 | 5.30 | 29,315 | 6.65 |
| | -40° F | 10,161 | 3.25 | 11,039 | 3.46 | 14,887 | 4.31 | 19,014 | 5.29 |
| 95° F | 0° | 34,743 | 6.31 | 41,635 | 7.37 | 49,989 | 9.17 | 61,566 | 12.02 |
| | -10° F | 26,509 | 5.43 | 31,589 | 6.22 | 38,737 | 7.74 | 48,399 | 9.99 |
| | -20° F | 19,524 | 4.61 | 22,926 | 5.16 | 28,824 | 6.43 | 36,371 | 8.16 |
| | -25° F | 16,416 | 4.22 | 19,037 | 4.65 | 24,371 | 5.82 | 30,853 | 7.32 |
| | -30° F | 13,601 | 3.86 | 15,430 | 4.18 | 20,206 | 5.24 | 25,640 | 6.53 |
| | -40° F | - | - | - | - | - | - | - | - |
| 105° F | 0° F | 31,210 | 6.42 | 37,077 | 7.43 | - | - | - | - |
| | -10° F | 23,615 | 5.48 | 27,841 | 6.21 | 34,462 | 7.79 | - | - |
| | -20° F | 17,197 | 4.60 | 19,856 | 5.07 | 25,384 | 6.40 | 31,956 | 8.08 |
| | -25° F | 14,364 | 4.19 | 16,314 | 4.54 | 21,300 | 5.76 | 26,860 | 7.20 |
| | -30° F | 11,784 | 3.81 | 13,005 | 4.03 | 17,500 | 5.15 | 22,076 | 6.37 |
| | -40° F | - | - | - | - | - | - | - | - |

1 - MCA (Minimum Circuit Ampacity) is calculated based on all concurrent loads applied to the circuit. (Largest load x 1.25 + 100% of all other loads including the control circuit.) Unit cooler amperages not included.

2 - Based on 80% full at 90°F ambient.

3 - Based on 50 ft. of equivalent refrigerant line piping. (Does not include the evaporator.)

4 - KW is for the unit.

5 - Rated in accordance with ANSI/AHRI Standard 520-2004.

6 - Operating weight reflects flooded refrigerant charge.

7 - Size based on mounted optional suction line trim.

8 - Contact factory to confirm single phase application selections.

“-” - Consult your local Century Representative.

NOTE: Compressor amps are based on the maximum cataloged suction temperature for the condensing unit. Limiting the operation to this envelope is required via a MOP expansion valve or other means.

| R-407c - Low Temp | | Model Numbers | | |
|--|-------------------------------|----------------------|---------------------|---------------------|
| | | BLU-B030L-7C | BLU-B035L-7C | BLU-B040L-7C |
| Compressor Model Number | | 2DES-2 | 4FES-3 | 4EES-4 |
| Compressor Motor Protection | | INHERENT | | |
| Unit MCA¹ | 208-230/1/60 V | - | - | - |
| | 208-230/3/60 V | 20.2 | 26.2 | 29.2 |
| | 460/3/60 V | 10.1 | 12.2 | 13.5 |
| Compressor RLA / LRA | 208-230/1/60 V | - | - | - |
| | 208-230/3/60 V | 13.1 | 17.9 | 20.3 |
| | 460/3/60 V | 6.4 | 8.1 | 9.2 |
| Total Number of Condenser Fan Motors | | 1 | 1 | 1 |
| Size of Motor (HP) | | 1.2 | 1.2 | 1.2 |
| Diameter of Blade (in.) | | ZN050.DC | ZN050.DC | ZN050.DC |
| Condenser Fan Motor Amps (each) | 208-230/1/60 V ⁸ | - | - | - |
| | 208-230/3/60 V | 2.8 | 2.8 | 2.8 |
| | 460/3/60 V | 1.6 | 1.6 | 1.6 |
| Receiver Size per circuit (in.) | | 8.625 x 16 | 8.625 x 16 | 8.625 x 16 |
| Receiver Capacity 80% Full per circuit (lbs.)² | | 23.2 | 23.2 | 23.2 |
| Unit Operating Charge per circuit (approx. lbs.) | Standard ³ | 12.8 | 14.3 | 15.3 |
| | w/ Flood Control ³ | 18.8 | 23.1 | 26.3 |
| Suction Connection per circuit - ODS (in.)⁷ | | 7/8 | 7/8 | 7/8 |
| Liquid Line Connection per circuit - ODS (in.) | | 0.5 | 0.5 | 0.5 |
| Unit Shipping Weight - Approximate (lbs.) | | 779 | 827 | 839 |
| Unit Operating Weight - Approximate (lbs.)⁶ | | 765 | 815 | 829 |

| Capacity Ratings | | Unit Model Numbers | | | | | |
|-------------------------|----------------------|---------------------------|-----------------------|---------------------|-----------------------|---------------------|-----------------------|
| Ambient Temp. | Suction Temp. | BLU-B030L-7C | | BLU-B035L-7C | | BLU-B040L-7C | |
| | | Capacity | KW⁴ | Capacity | KW⁴ | Capacity | KW⁴ |
| 85° F | 0° F | 19,045 | 3.51 | 24,367 | 4.16 | 30,249 | 4.97 |
| | -10° F | 14,557 | 3.14 | 18,424 | 3.68 | 22,925 | 4.33 |
| | -20° F | - | - | - | - | - | - |
| | -25° F | - | - | - | - | - | - |
| | -30° F | - | - | - | - | - | - |
| | -40° F | - | - | - | - | - | - |
| 95° F | 0° F | 17,441 | 3.60 | 22,153 | 4.24 | 27,458 | 5.07 |
| | -10° F | 13,263 | 3.20 | 16,611 | 3.72 | 20,664 | 4.38 |
| | -20° F | - | - | - | - | - | - |
| | -25° F | - | - | - | - | - | - |
| | -30° F | - | - | - | - | - | - |
| | -40° F | - | - | - | - | - | - |
| 105° F | 0° F | 15,836 | 3.67 | 19,893 | 4.29 | 24,670 | 5.12 |
| | -10° F | 11,947 | 3.23 | 14,771 | 3.72 | 18,372 | 4.38 |
| | -20° F | - | - | - | - | - | - |
| | -25° F | - | - | - | - | - | - |
| | -30° F | - | - | - | - | - | - |
| | -40° F | - | - | - | - | - | - |

1 - MCA (Minimum Circuit Ampacity) is calculated based on all concurrent loads applied to the circuit. (Largest load x 1.25 + 100% of all other loads including the control circuit.) Unit cooler amperages not included.

2 - Based on 80% full at 90°F ambient.

3 - Based on 50 ft. of equivalent refrigerant line piping. (Does not include the evaporator.)

4 - KW is for the unit.

5 - Rated in accordance with ANSI/AHRI Standard 520-2004.

6 - Operating weight reflects flooded refrigerant charge.

7 - Size based on mounted optional suction line trim.

8 - Contact factory to confirm single phase application selections.

“-” - Consult your local Century Representative.

NOTE: Compressor amps are based on the maximum cataloged suction temperature for the condensing unit. Limiting the operation to this envelope is required via a MOP expansion valve or other means.

| R-407c - Low Temp | | Model Numbers | | | |
|--|-------------------------------|----------------------|---------------------|---------------------|---------------------|
| | | BLU-B050L-7C | BLU-B060L-7C | BLU-B075L-7C | BLU-B100L-7C |
| Compressor Model Number | | 4DES-5 | 4VE(S)-7 | 4TE(S)-9 | 4NE(S)-14 |
| Compressor Motor Protection | | INHERENT | | | |
| Unit MCA¹ | 208-230/1/60 V | - | - | - | - |
| | 208-230/3/60 V | 33.7 | 37.5 | 47.2 | 58.8 |
| | 460/3/60 V | 15.6 | 17.3 | 21.7 | 26.9 |
| Compressor RLA / LRA | 208-230/1/60 V | - | - | - | - |
| | 208-230/3/60 V | 23.9 | 27.0 | 34.7 | 44.0 |
| | 460/3/60 V | 10.8 | 12.2 | 15.7 | 19.9 |
| Total Number of Condenser Fan Motors | | 1 | 1 | 1 | 1 |
| Size of Motor (HP) | | 1.2 | 1.2 | 1.2 | 1.2 |
| Diameter of Blade (in.) | | ZN050.DC | ZN050.DC | ZN050.DC | ZN050.DC |
| Condenser Fan Motor Amps (each) | 208-230/1/60 V ⁸ | - | - | - | - |
| | 208-230/3/60 V | 2.8 | 2.8 | 2.8 | 2.8 |
| | 460/3/60 V | 1.6 | 1.6 | 1.6 | 1.6 |
| Receiver Size per circuit (in.) | | 10.75 x 18 | 10.75 x 18 | 10.75 x 18 | 10.75 x 18 |
| Receiver Capacity 80% Full per circuit (lbs.)² | | 39.2 | 39.2 | 39.2 | 39.2 |
| Unit Operating Charge per circuit (approx. lbs.) | Standard ³ | 20.9 | 20.9 | 22.7 | 23.2 |
| | w/ Flood Control ³ | 36.8 | 36.8 | 38.6 | 39.1 |
| Suction Connection per circuit - ODS (in.)⁷ | | 7/8 | 1 1/8 | 1 1/8 | 1 3/8 |
| Liquid Line Connection per circuit - ODS (in.) | | 0.5 | 0.5 | 0.625 | 0.625 |
| Unit Shipping Weight - Approximate (lbs.) | | 858 | 968 | 958 | 999 |
| Unit Operating Weight - Approximate (lbs.)⁶ | | 848 | 960 | 950 | 987 |

| Capacity Ratings | | Unit Model Numbers | | | | | | | |
|-------------------------|----------------------|---------------------------|-----------------------|---------------------|-----------------------|---------------------|-----------------------|---------------------|-----------------------|
| Ambient Temp. | Suction Temp. | BLU-B050L-7C | | BLU-B060L-7C | | BLU-B075L-7C | | BLU-B100L-7C | |
| | | Capacity | KW⁴ | Capacity | KW⁴ | Capacity | KW⁴ | Capacity | KW⁴ |
| 85° F | 0° F | 36,470 | 5.79 | 45,096 | 7.04 | 53,065 | 8.51 | 65,921 | 11.19 |
| | -10° F | 27,743 | 5.06 | 34,418 | 6.02 | 41,079 | 7.25 | 51,786 | 9.38 |
| | -20° F | - | - | - | - | - | - | - | - |
| | -25° F | - | - | - | - | - | - | - | - |
| | -30° F | - | - | - | - | - | - | - | - |
| | -40° F | - | - | - | - | - | - | - | - |
| 95° F | 0° | 33,190 | 5.92 | 40,756 | 7.14 | 48,101 | 8.65 | 59,525 | 11.27 |
| | -10° F | 25,120 | 5.13 | 30,891 | 6.05 | 37,060 | 7.31 | 46,532 | 9.38 |
| | -20° F | - | - | - | - | - | - | - | - |
| | -25° F | - | - | - | - | - | - | - | - |
| | -30° F | - | - | - | - | - | - | - | - |
| | -40° F | - | - | - | - | - | - | - | - |
| 105° F | 0° F | 29,911 | 6.01 | 36,415 | 7.18 | 43,148 | 8.73 | - | - |
| | -10° F | 22,460 | 5.16 | 27,356 | 6.02 | 32,997 | 7.31 | - | - |
| | -20° F | - | - | - | - | - | - | - | - |
| | -25° F | - | - | - | - | - | - | - | - |
| | -30° F | - | - | - | - | - | - | - | - |
| | -40° F | - | - | - | - | - | - | - | - |

1 - MCA (Minimum Circuit Ampacity) is calculated based on all concurrent loads applied to the circuit. (Largest load x 1.25 + 100% of all other loads including the control circuit.) Unit cooler amperages not included.

2 - Based on 80% full at 90°F ambient.

3 - Based on 50 ft. of equivalent refrigerant line piping. (Does not include the evaporator.)

4 - KW is for the unit.

5 - Rated in accordance with ANSI/AHRI Standard 520-2004.

6 - Operating weight reflects flooded refrigerant charge.

7 - Size based on mounted optional suction line trim.

8 - Contact factory to confirm single phase application selections.

“-” - Consult your local Century Representative.

NOTE: Compressor amps are based on the maximum cataloged suction temperature for the condensing unit. Limiting the operation to this envelope is required via a MOP expansion valve or other means.

| R-407f - Low Temp | | Model Numbers | | |
|--|-------------------------------|----------------------|---------------------|---------------------|
| | | BLU-B030L-7F | BLU-B035L-7F | BLU-B040L-7F |
| Compressor Model Number | | 2DES-2 | 4FES-3 | 4EES-4 |
| Compressor Motor Protection | | INHERENT | | |
| Unit MCA¹ | 208-230/1/60 V | - | - | - |
| | 208-230/3/60 V | 20.2 | 26.2 | 29.2 |
| | 460/3/60 V | 10.1 | 12.2 | 13.5 |
| Compressor RLA / LRA | 208-230/1/60 V | - | - | - |
| | 208-230/3/60 V | 13.1 | 17.9 | 20.3 |
| | 460/3/60 V | 6.4 | 8.1 | 9.2 |
| Total Number of Condenser Fan Motors | | 1 | 1 | 1 |
| Size of Motor (HP) | | 1.2 | 1.2 | 1.2 |
| Diameter of Blade (in.) | | ZN050.DC | ZN050.DC | ZN050.DC |
| Condenser Fan Motor Amps (each) | 208-230/1/60 V ⁸ | - | - | - |
| | 208-230/3/60 V | 2.8 | 2.8 | 2.8 |
| | 460/3/60 V | 1.6 | 1.6 | 1.6 |
| Receiver Size per circuit (in.) | | 8.625 x 16 | 8.625 x 16 | 8.625 x 16 |
| Receiver Capacity 80% Full per circuit (lbs.)² | | 23.2 | 23.2 | 23.2 |
| Unit Operating Charge per circuit (approx. lbs.) | Standard ³ | 12.8 | 14.3 | 15.3 |
| | w/ Flood Control ³ | 18.8 | 23.1 | 26.3 |
| Suction Connection per circuit - ODS (in.)⁷ | | 7/8 | 7/8 | 7/8 |
| Liquid Line Connection per circuit - ODS (in.) | | 0.5 | 0.5 | 0.5 |
| Unit Shipping Weight - Approximate (lbs.) | | 779 | 827 | 839 |
| Unit Operating Weight - Approximate (lbs.)⁶ | | 765 | 815 | 829 |

| Capacity Ratings | | Unit Model Numbers | | | | | |
|-------------------------|----------------------|---------------------------|-----------------------|---------------------|-----------------------|---------------------|-----------------------|
| Ambient Temp. | Suction Temp. | BLU-B030L-7F | | BLU-B035L-7F | | BLU-B040L-7F | |
| | | Capacity | KW⁴ | Capacity | KW⁴ | Capacity | KW⁴ |
| 85° F | 0° F | 20,679 | 3.78 | 28,027 | 4.75 | 34,505 | 5.71 |
| | -10° F | 15,851 | 3.34 | 21,562 | 4.17 | 26,597 | 4.94 |
| | -20° F | 11,748 | 2.93 | 16,081 | 3.63 | 19,870 | 4.23 |
| | -25° F | 9,925 | 2.73 | 13,675 | 3.37 | 16,912 | 3.90 |
| | -30° F | 8,269 | 2.54 | 11,465 | 3.13 | 14,172 | 3.58 |
| | -40° F | 5,391 | 2.19 | 7,630 | 2.68 | 9,403 | 3.00 |
| 95° F | 0° | 18,819 | 3.88 | 25,531 | 4.89 | 31,389 | 5.89 |
| | -10° F | 14,328 | 3.40 | 19,528 | 4.26 | 24,055 | 5.06 |
| | -20° F | 10,510 | 2.94 | 14,448 | 3.68 | 17,827 | 4.29 |
| | -25° F | 8,816 | 2.73 | 12,214 | 3.40 | 15,067 | 3.93 |
| | -30° F | 7,283 | 2.53 | 10,164 | 3.14 | 12,537 | 3.59 |
| | -40° F | 4,606 | 2.15 | 6,618 | 2.66 | 8,130 | 2.98 |
| 105° F | 0° F | 16,985 | 3.95 | 23,094 | 5.01 | 28,352 | 6.02 |
| | -10° F | 12,808 | 3.43 | 17,526 | 4.33 | 21,556 | 5.13 |
| | -20° F | 9,277 | 2.94 | 12,850 | 3.71 | 15,824 | 4.32 |
| | -25° F | 7,718 | 2.71 | 10,785 | 3.41 | 13,275 | 3.94 |
| | -30° F | 6,296 | 2.49 | 8,907 | 3.14 | 10,945 | 3.58 |
| | -40° F | 3,818 | 2.09 | 5,637 | 2.63 | 6,888 | 2.93 |

1 - MCA (Minimum Circuit Ampacity) is calculated based on all concurrent loads applied to the circuit. (Largest load x 1.25 + 100% of all other loads including the control circuit.) Unit cooler amperages not included.

2 - Based on 80% full at 90°F ambient.

3 - Based on 50 ft. of equivalent refrigerant line piping. (Does not include the evaporator.)

4 - KW is for the unit.

5 - Rated in accordance with ANSI/AHRI Standard 520-2004.

6 - Operating weight reflects flooded refrigerant charge.

7 - Size based on mounted optional suction line trim.

8 - Contact factory to confirm single phase application selections.

"-" - Consult your local Century Representative.

NOTE: Compressor amps are based on the maximum cataloged suction temperature for the condensing unit. Limiting the operation to this envelope is required via a MOP expansion valve or other means.

| R-407f - Low Temp | | Model Numbers | | | |
|--|-------------------------------|----------------------|---------------------|---------------------|---------------------|
| | | BLU-B050L-7F | BLU-B060L-7F | BLU-B075L-7F | BLU-B100L-7F |
| Compressor Model Number | | 4DES-5 | 4VE(S)-7 | 4TE(S)-9 | 4NE(S)-14 |
| Compressor Motor Protection | | INHERENT | | | |
| Unit MCA¹ | 208-230/1/60 V | - | - | - | - |
| | 208-230/3/60 V | 33.7 | 37.5 | 47.2 | 58.8 |
| | 460/3/60 V | 15.6 | 17.3 | 21.7 | 26.9 |
| Compressor RLA / LRA | 208-230/1/60 V | - | - | - | - |
| | 208-230/3/60 V | 23.9 | 27.0 | 34.7 | 44.0 |
| | 460/3/60 V | 10.8 | 12.2 | 15.7 | 19.9 |
| Total Number of Condenser Fan Motors | | 1 | 1 | 1 | 1 |
| Size of Motor (HP) | | 1.2 | 1.2 | 1.2 | 1.2 |
| Diameter of Blade (in.) | | ZN050.DC | ZN050.DC | ZN050.DC | ZN050.DC |
| Condenser Fan Motor Amps (each) | 208-230/1/60 V ⁸ | - | - | - | - |
| | 208-230/3/60 V | 2.8 | 2.8 | 2.8 | 2.8 |
| | 460/3/60 V | 1.6 | 1.6 | 1.6 | 1.6 |
| Receiver Size per circuit (in.) | | 10.75 x 18 | 10.75 x 18 | 10.75 x 18 | 10.75 x 18 |
| Receiver Capacity 80% Full per circuit (lbs.)² | | 39.2 | 39.2 | 39.2 | 39.2 |
| Unit Operating Charge per circuit (approx. lbs.) | Standard ³ | 20.9 | 20.9 | 22.7 | 23.2 |
| | w/ Flood Control ³ | 36.8 | 36.8 | 38.6 | 39.1 |
| Suction Connection per circuit - ODS (in.)⁷ | | 7/8 | 1 1/8 | 1 1/8 | 1 3/8 |
| Liquid Line Connection per circuit - ODS (in.) | | 0.5 | 0.5 | 0.625 | 0.625 |
| Unit Shipping Weight - Approximate (lbs.) | | 858 | 968 | 958 | 999 |
| Unit Operating Weight - Approximate (lbs.)⁶ | | 848 | 960 | 950 | 987 |

| Capacity Ratings | | Unit Model Numbers | | | | | | | |
|-------------------------|----------------------|---------------------------|-----------------------|---------------------|-----------------------|---------------------|-----------------------|---------------------|-----------------------|
| Ambient Temp. | Suction Temp. | BLU-B050L-7F | | BLU-B060L-7F | | BLU-B075L-7F | | BLU-B100L-7F | |
| | | Capacity | KW⁴ | Capacity | KW⁴ | Capacity | KW⁴ | Capacity | KW⁴ |
| 85° F | 0° F | 40,629 | 6.51 | 48,854 | 7.81 | 57,443 | 9.50 | 71,253 | 12.58 |
| | -10° F | 31,245 | 5.63 | 37,590 | 6.64 | 44,837 | 8.04 | 56,487 | 10.46 |
| | -20° F | 23,275 | 4.82 | 27,721 | 5.55 | 33,592 | 6.68 | 42,775 | 8.54 |
| | -25° F | 19,763 | 4.44 | 23,337 | 5.03 | 28,475 | 6.04 | 36,447 | 7.65 |
| | -30° F | 16,533 | 4.07 | 19,265 | 4.53 | 23,777 | 5.43 | 30,486 | 6.81 |
| | -40° F | 10,922 | 3.40 | 12,014 | 3.59 | 15,281 | 4.29 | 19,610 | 5.24 |
| 95° F | 0° | 36,931 | 6.68 | 44,088 | 7.95 | 52,018 | 9.69 | - | - |
| | -10° F | 28,225 | 5.73 | 33,617 | 6.70 | 40,322 | 8.13 | 50,636 | 10.51 |
| | -20° F | 20,846 | 4.85 | 24,427 | 5.52 | 29,811 | 6.68 | 37,857 | 8.48 |
| | -25° F | 17,585 | 4.44 | 20,300 | 4.96 | 25,030 | 6.00 | 31,907 | 7.54 |
| | -30° F | 14,589 | 4.05 | 16,441 | 4.42 | 20,573 | 5.34 | 26,261 | 6.64 |
| | -40° F | 9,409 | 3.34 | 9,563 | 3.40 | - | - | - | - |
| 105° F | 0° F | 33,327 | 6.81 | 39,417 | 8.04 | - | - | - | - |
| | -10° F | 25,257 | 5.79 | 29,718 | 6.70 | 35,831 | 8.17 | - | - |
| | -20° F | 18,466 | 4.85 | 21,188 | 5.43 | 26,083 | 6.62 | 32,960 | 8.35 |
| | -25° F | 15,457 | 4.41 | 17,301 | 4.83 | 21,586 | 5.90 | 27,380 | 7.35 |
| | -30° F | 12,715 | 4.00 | 13,662 | 4.25 | 17,400 | 5.20 | 22,041 | 6.40 |
| | -40° F | 7,946 | 3.25 | 7,142 | 3.18 | - | - | - | - |

1 - MCA (Minimum Circuit Ampacity) is calculated based on all concurrent loads applied to the circuit. (Largest load x 1.25 + 100% of all other loads including the control circuit.) Unit cooler amperages not included.

2 - Based on 80% full at 90°F ambient.

3 - Based on 50 ft. of equivalent refrigerant line piping. (Does not include the evaporator.)

4 - KW is for the unit.

5 - Rated in accordance with ANSI/AHRI Standard 520-2004.

6 - Operating weight reflects flooded refrigerant charge.

7 - Size based on mounted optional suction line trim.

8 - Contact factory to confirm single phase application selections.

“-” - Consult your local Century Representative.

NOTE: Compressor amps are based on the maximum cataloged suction temperature for the condensing unit. Limiting the operation to this envelope is required via a MOP expansion valve or other means.

AWEF Tables

| AWEF Data | | | | | | | |
|------------|-------|-------|-------|-------|-------|------|-------|
| | R448a | R449a | R407a | R407c | R407f | R507 | R404a |
| BLU-B-030L | 3.15 | 3.15 | 3.15 | N/A | 3.15 | 3.15 | 3.15 |
| BLU-B-035L | 3.15 | 3.15 | 3.15 | N/A | 3.15 | 3.15 | 3.15 |
| BLU-B-040L | 3.15 | 3.15 | 3.15 | N/A | 3.15 | 3.15 | 3.15 |
| BLU-B-050L | 3.15 | 3.15 | 3.15 | N/A | 3.15 | 3.15 | 3.15 |
| BLU-B-060L | 3.15 | 3.15 | 3.15 | N/A | 3.15 | 3.15 | 3.15 |
| BLU-B-075L | 3.15 | 3.15 | 3.15 | N/A | 3.15 | 3.15 | 3.15 |
| BLU-B-100L | 3.15 | 3.15 | 3.15 | N/A | 3.15 | 3.15 | 3.15 |

| AWEF Data | | | | | | | |
|------------|-------|-------|-------|-------|-------|------|-------|
| | R448a | R449a | R407a | R407c | R407f | R507 | R404a |
| BLU-B-020M | 7.6 | 7.6 | 7.6 | 7.6 | 7.6 | 7.6 | 7.6 |
| BLU-B-025M | 7.6 | 7.6 | 7.6 | 7.6 | 7.6 | 7.6 | 7.6 |
| BLU-B-030M | 7.6 | 7.6 | 7.6 | 7.6 | 7.6 | 7.6 | 7.6 |
| BLU-B-035M | 7.6 | 7.6 | 7.6 | 7.6 | 7.6 | 7.6 | 7.6 |
| BLU-B-040M | 7.6 | 7.6 | 7.6 | 7.6 | 7.6 | 7.6 | 7.6 |
| BLU-B-050M | 7.6 | 7.6 | 7.6 | 7.6 | 7.6 | 7.6 | 7.6 |
| BLU-B-060M | 7.6 | 7.6 | 7.6 | 7.6 | 7.6 | 7.6 | 7.6 |
| BLU-B-075M | 7.6 | 7.6 | 7.6 | 7.6 | 7.6 | 7.6 | 7.6 |
| BLU-B-090M | 7.6 | 7.6 | 7.6 | 7.6 | 7.6 | 7.6 | 7.6 |

Dimensional Data

MINIMUM RECOMMENDED SERVICE CLEARANCES
 "Please refer to the Installation, Operation and Maintenance Manual for installation recommendations"

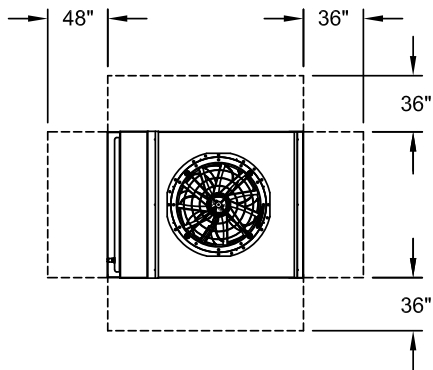

* .625 Dia. Unit Mounting Holes
 All Dims +/- .25"
 Unit Shown With Some Optional Components

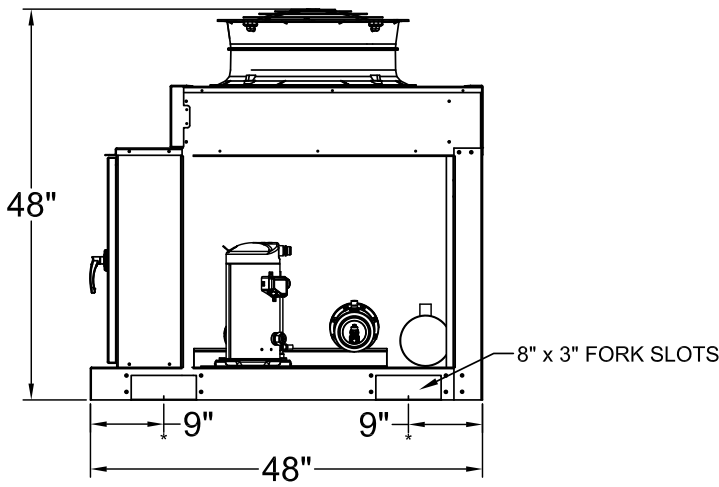
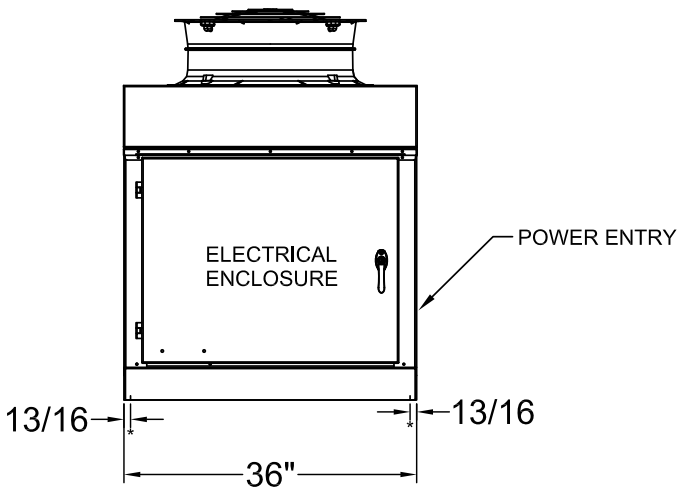
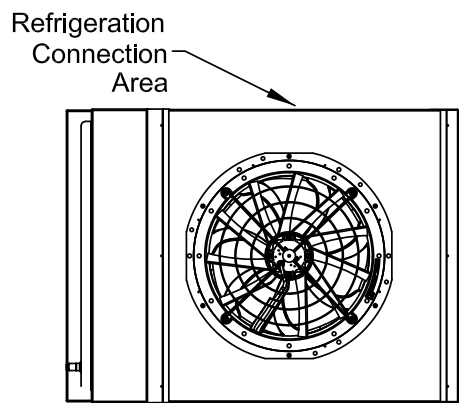

Product Benefits:

Adaptability

Century systems go where others can't. Your Century system is engineered to meet your specific project application and job requirements in-house with no need for modification in the field. With Century's extensive inventory of components, your order can be shipped when you need it.

Durability

Your Century system will be built with heavy gauge construction and the highest quality components to optimize efficiency for the life expectancy of your system. Century systems are engineered for Time Tested Toughness.

Serviceability

Your Century system will have easily accessible components and appropriate fin spacing to allow for easy maintenance. Century systems are engineered to be serviceable with a minimal amount of OEM components. A large inventory of replacement parts ensures professional, reliable service throughout the lifetime of your Century system.

Reduced Total Cost of Ownership

The adaptability, durability, and serviceability of your Century system results in reduced installation costs, maintenance costs, and utility costs throughout the lifetime of your system. Century systems are designed for customers requiring long-term, dependable systems.

The current refrigeration market...

Commercial Refrigeration

- Shipped from stock
- No modifications available; one size fits all equipment
- Lightweight construction
- Convenience store and restaurant applications
- Options/kits shipped loose for field assembly installation
- Cheaper, lower quality materials

Industrial Refrigeration

- Central refrigeration plant
- Dedicated mechanical rooms
- Stationary Engineer requirements
- PLC (Microprocessor) controls
- Steel construction
- Requires extensive piping in the field

now
presenting...

Comdustrial™ Refrigeration

Comdustrial™ Refrigeration Systems are the ideal balance of the commercial and industrial refrigeration markets.

- Industrial quality equipment in Commercial capacity ranges
- Built-to-order refrigeration systems with exceptional lead times
- Professionally represented by systems oriented Sales Representatives
- Systems based approach to your application
- Project specific submittal packages and drawings
- Quality materials for long-term equipment life

ABOUT RAE CORPORATION

RAE Corporation was founded in 1971 and is located in the MidAmerica Industrial Park in Pryor, Oklahoma. RAE employs more than 350 people, is represented throughout the country and markets equipment throughout the world. RAE manufactures air and water cooled condensing units, air and water cooled chillers, air cooled condensers, fluid coolers, heat transfer coils, industrial coils, unit coolers, corrosive environment equipment and an assortment of other engineered cooling systems, all of which are either UL- or ETL-approved. RAE has five divisions: Technical Systems, Refrigeration Systems, Century Refrigeration, RAE Coils and ZeroCool Systems.



4492 Hunt St. - Pryor, OK 74361 - (918) 825-7222 - Fax (800) 264-5329

www.century-refrigeration.com

We reserve the right to change or revise specifications and product design in connection with any feature of our products. Such changes do not entitle the buyer to corresponding changes, improvements, additions or replacement for equipment previously sold or shipped.

Bulletin# C-TC-BLU-B-0820